

REFUGE

- Upscale 2021 -

In the midst of a busy urban corridor lies a pocket of nature. Nestled between two roads, the two platforms face one another across the tracks and are sheltered by a canopy of vegetation that gently filters natural light down below. Traffic noise is mediated by the vegetation wall. The view from either end of the platforms is transformed into an urban oasis. Whilst waiting for the tram, pedestrians are invited into a refuge for quiet contemplation and interaction. Drawing upon Frank Lloyd Wright's idea of prospect refuge, a timber canopy slopes up from the seated vantage point, opening up the view to the sky, whilst providing a sense of security at the back. A previously ordinary tram stop becomes an island of greenery.

The modular terracotta planter boxes evoke a sense of the suburban Australian vernacular of the red brick façade, as evident across the road. An arch way guides the pedestrian into the sanctuary, where they can sit and wait. But there's really no rush ...

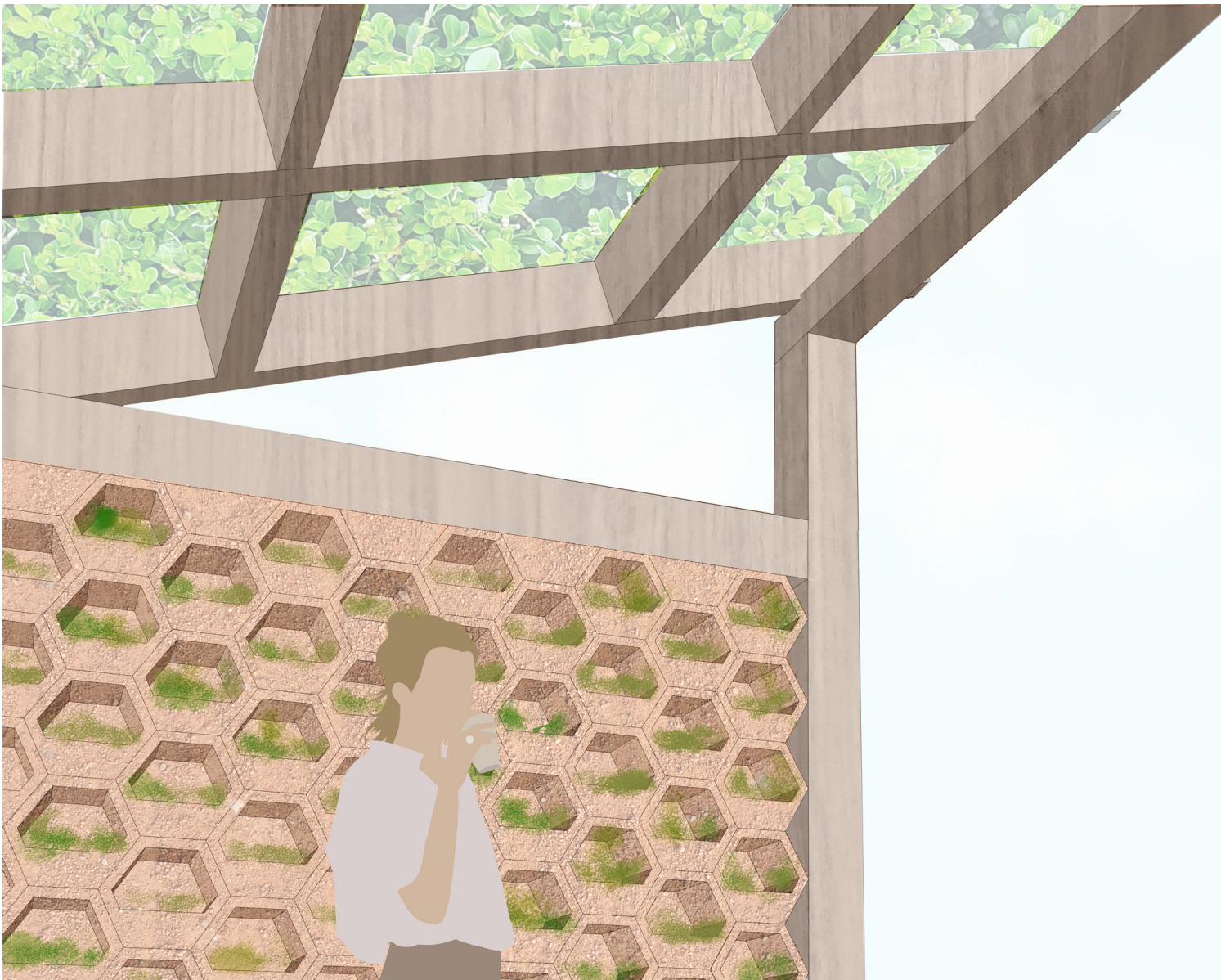

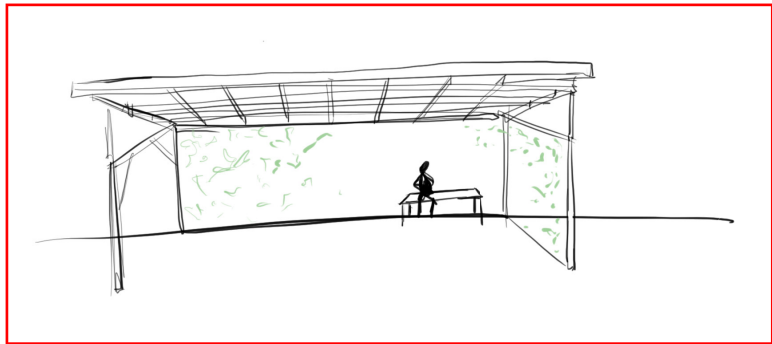

Visualisation of the Prospect Refuge Experience
by changing the Canopy and Wall

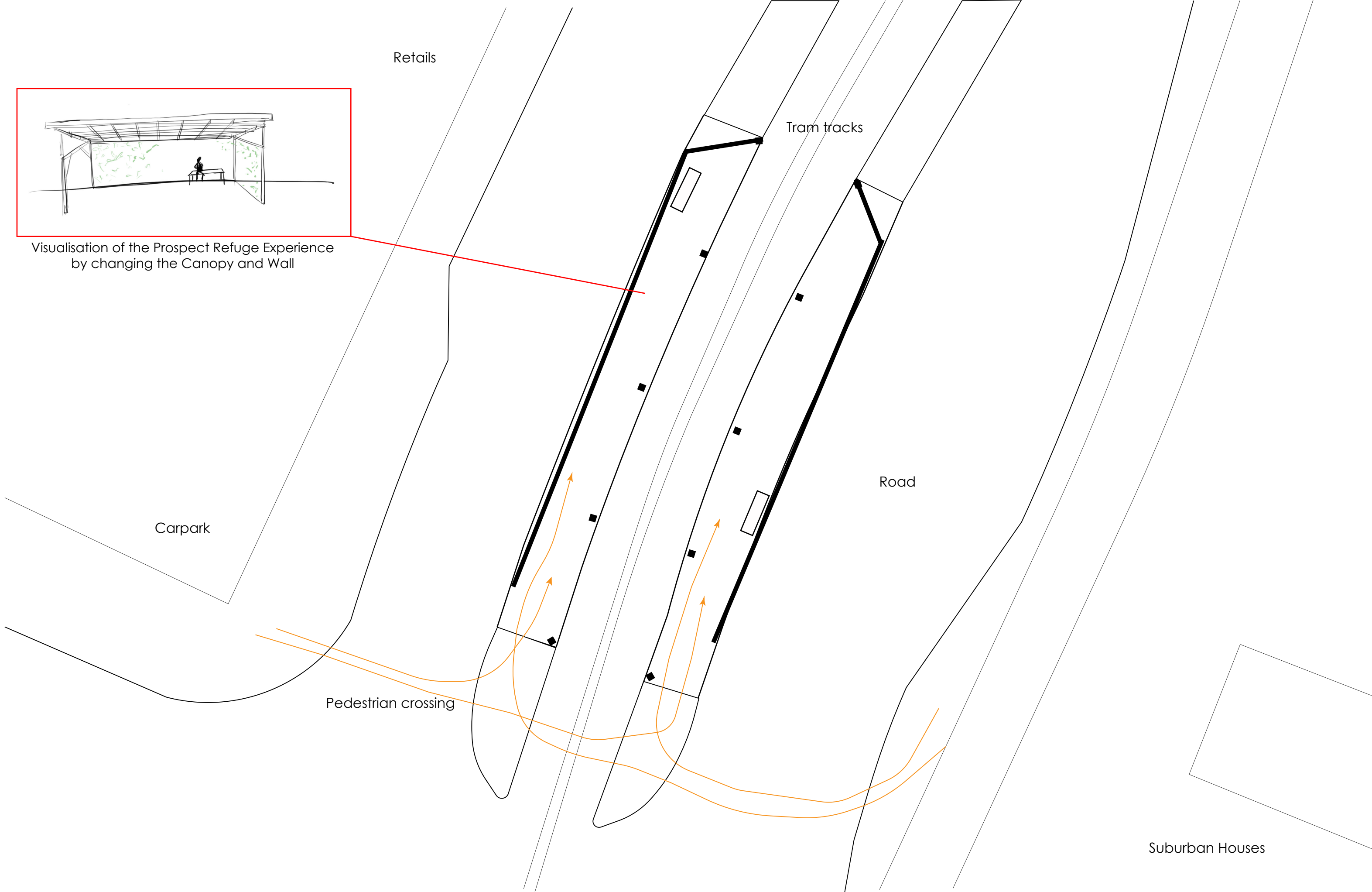



Marquette Model exploring the enclosure

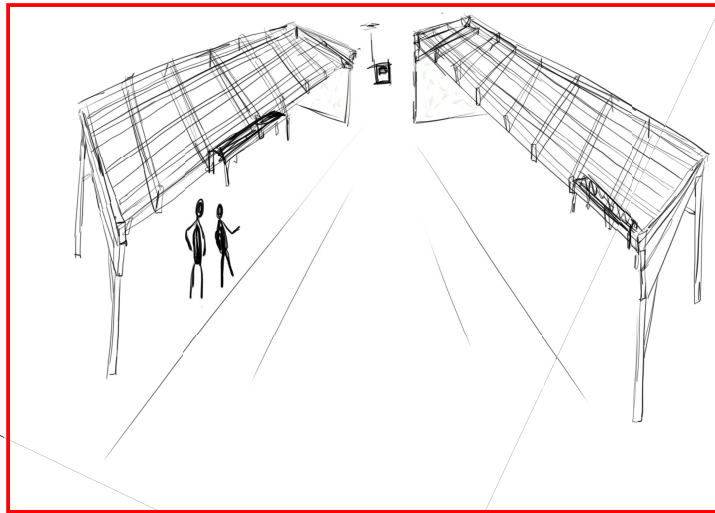

Visualisation of the Enclosure

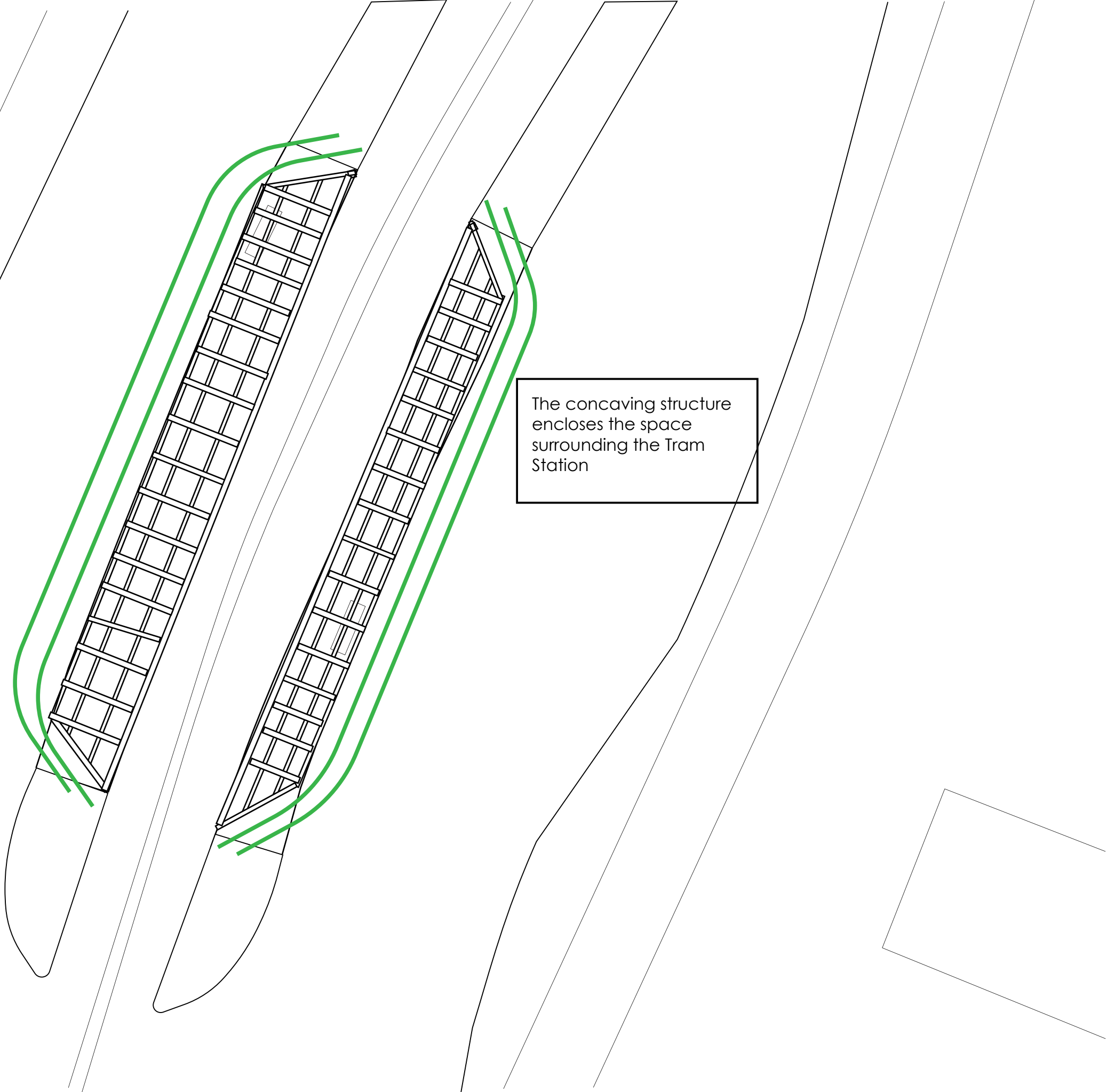

The concaving structure
encloses the space
surrounding the Tram
Station

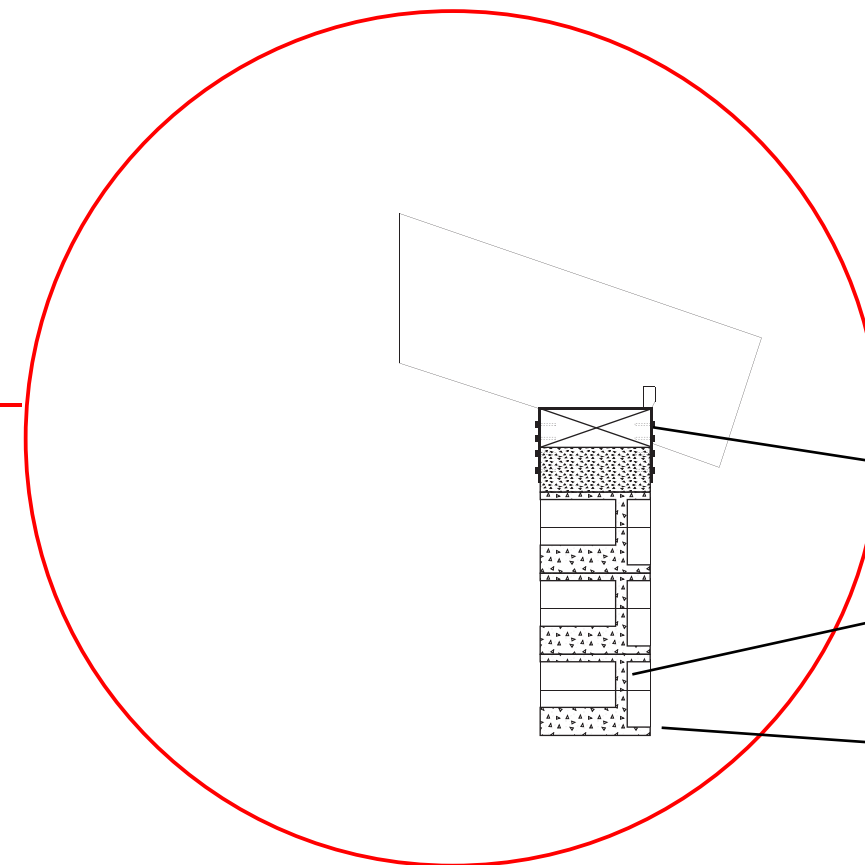
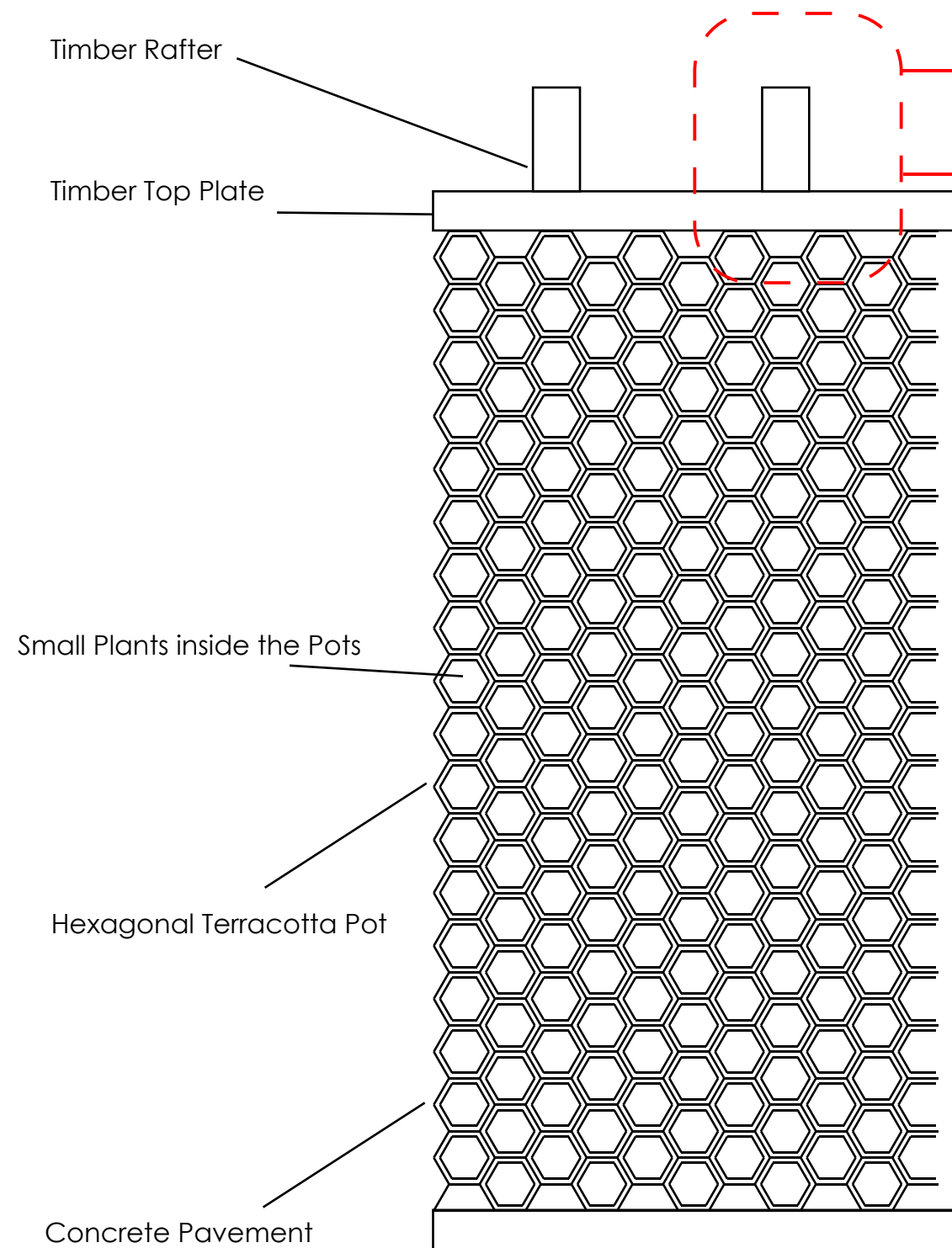

Canopy to Wall Connection A - 1 to 5 @A3

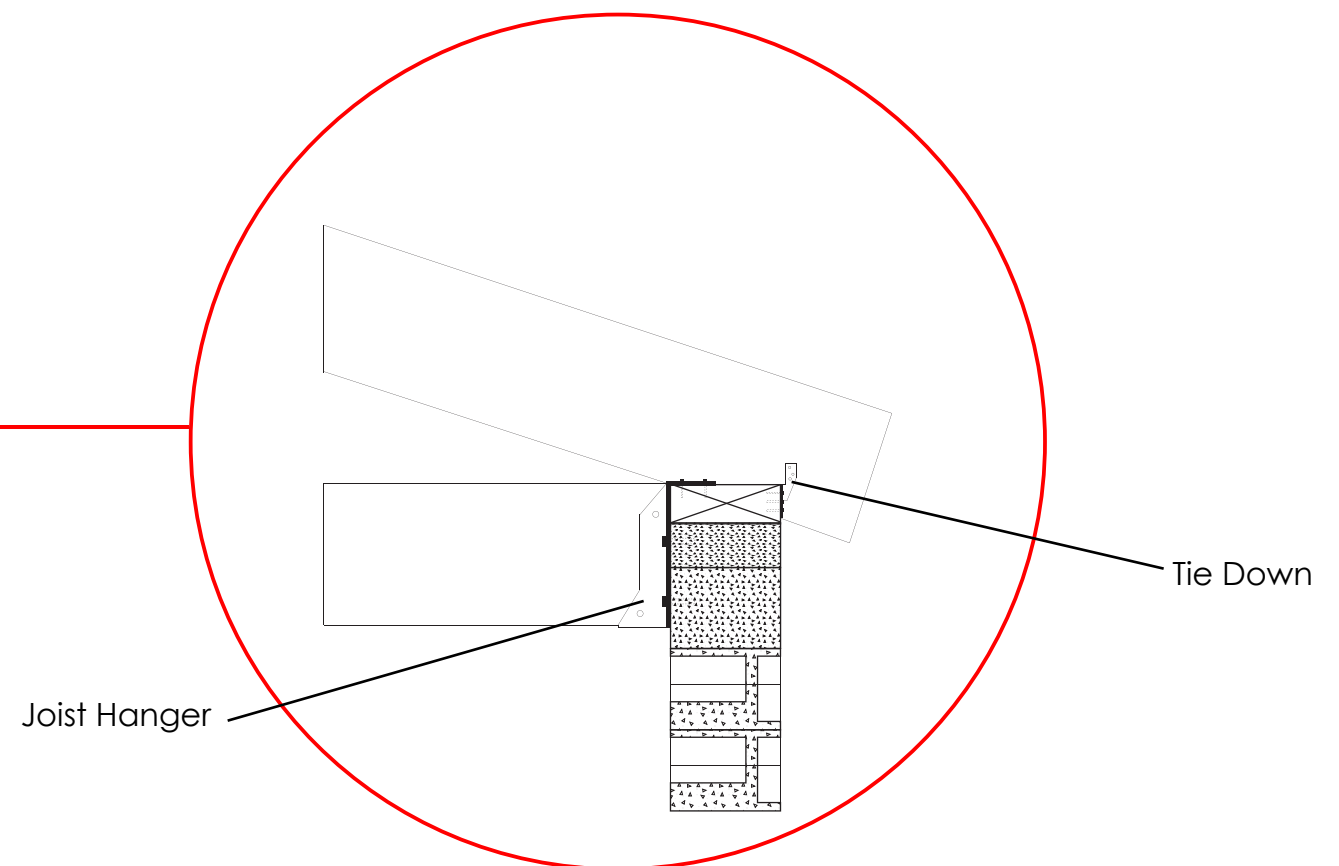

Canopy to Wall Connection B - 1 to 5 @A3

