

Paint Your Commute

MATERIAL

Paint Your Commute aims to introduce the colourful ambience to the daily commute in the form of a tram station waiting area. The creative approach incorporates the movement of the glass panel within the linear form. Thus, this allows the occupants to not only interact with the structure but also evokes the sense of ownership through their interaction. Indeed, as the panel are made from tinted recycled glass, its mobility through the clipping mechanism offers the commuter a chance to shuffle the panels or bring it home.



OLD GLASS



Use of old glasses from existing infrastructure like old train, bus or tram to be re-developed and tinted for the stained glass effect

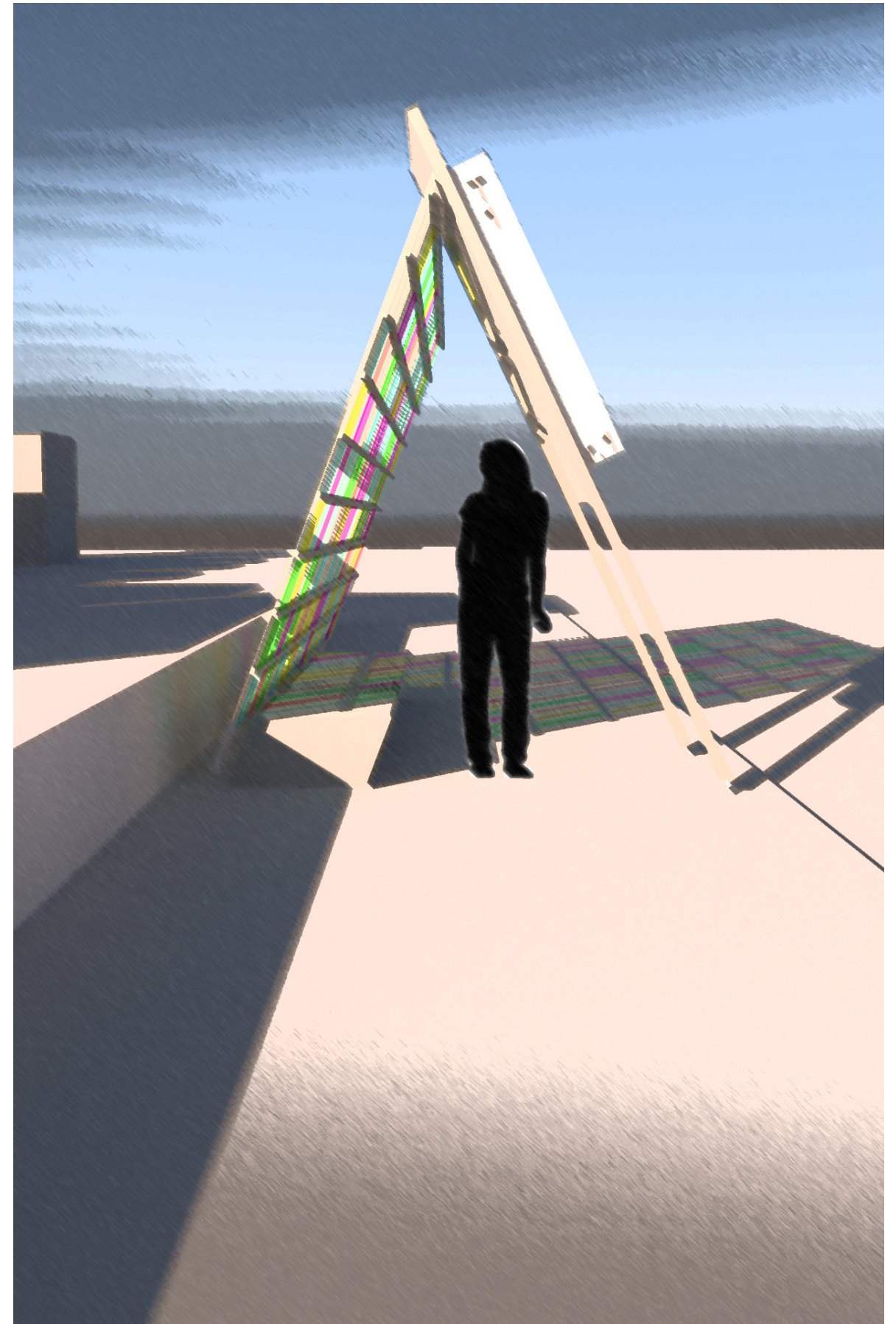
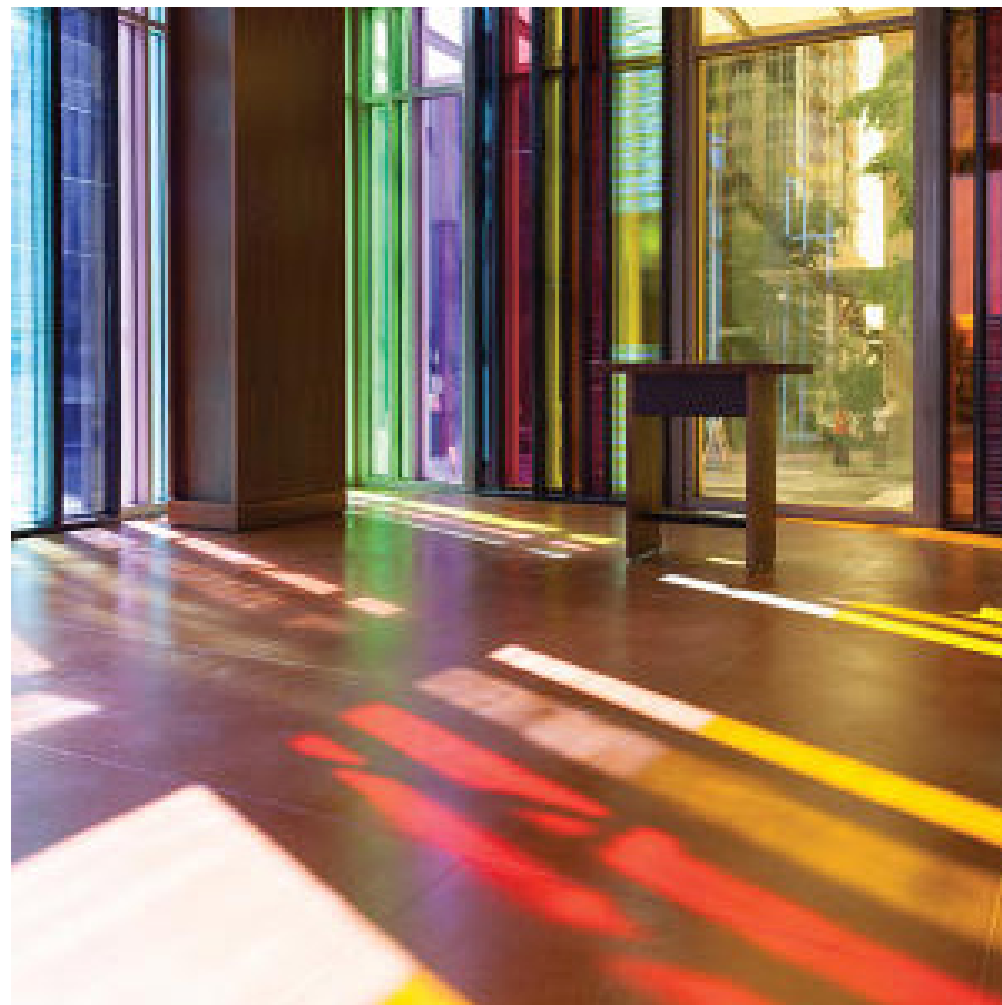

INTERACTIVE ELEMENT

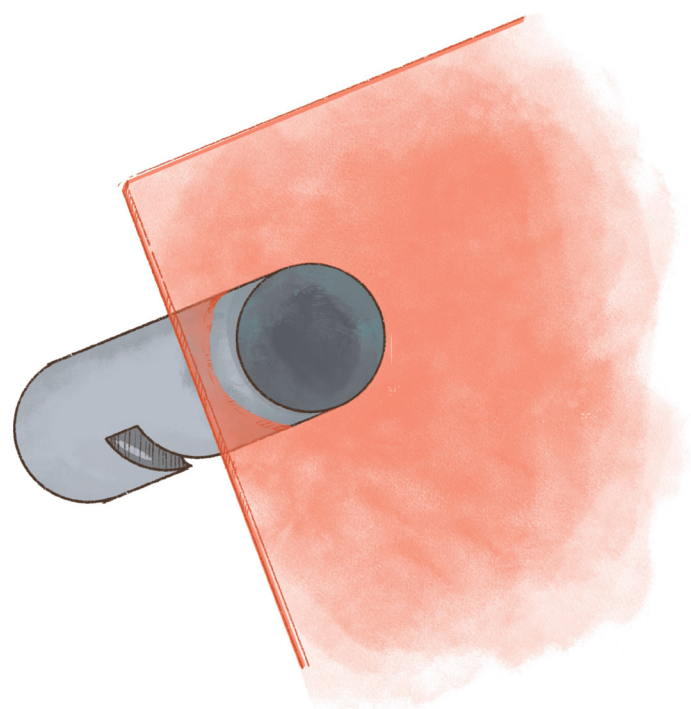
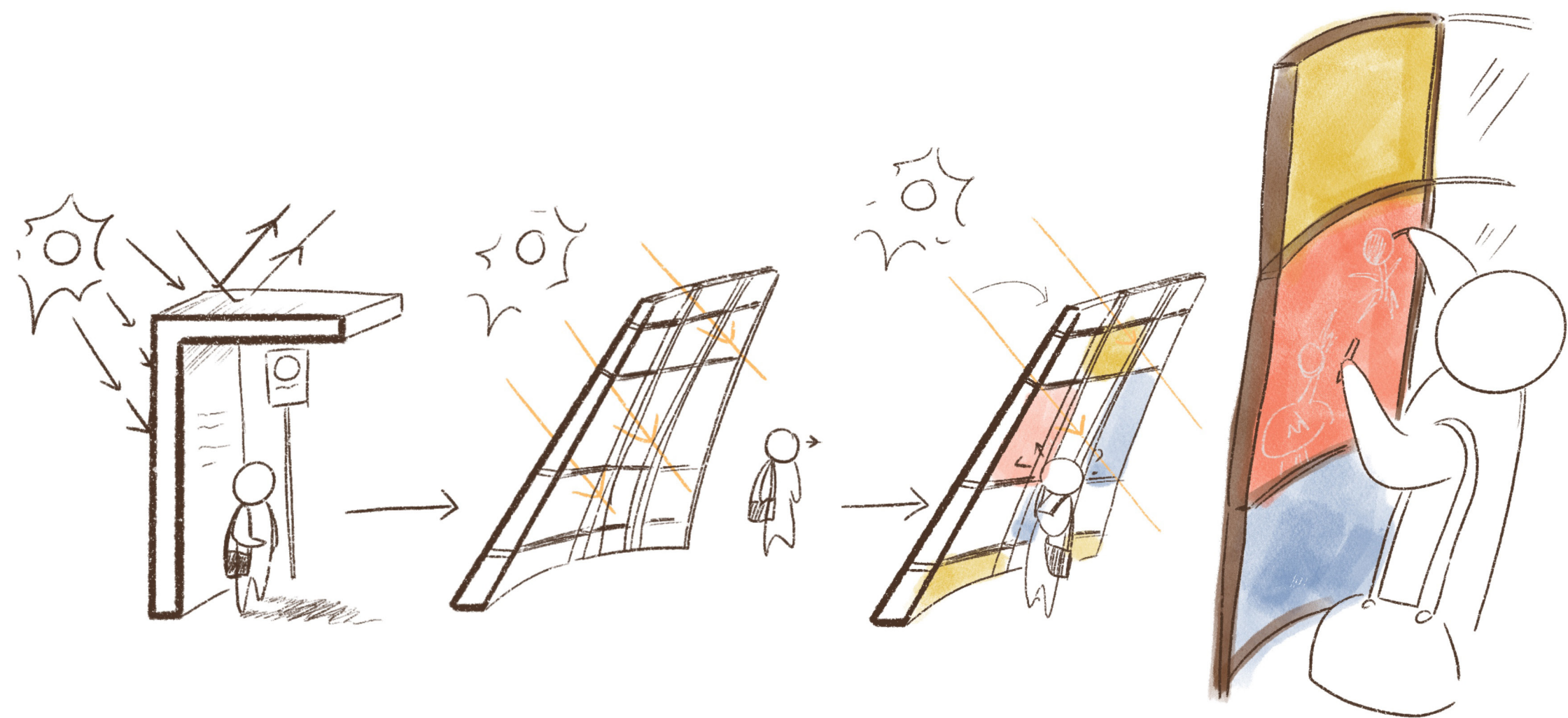

CLIPPING ELEMMENT CLOSEUP
Page 2

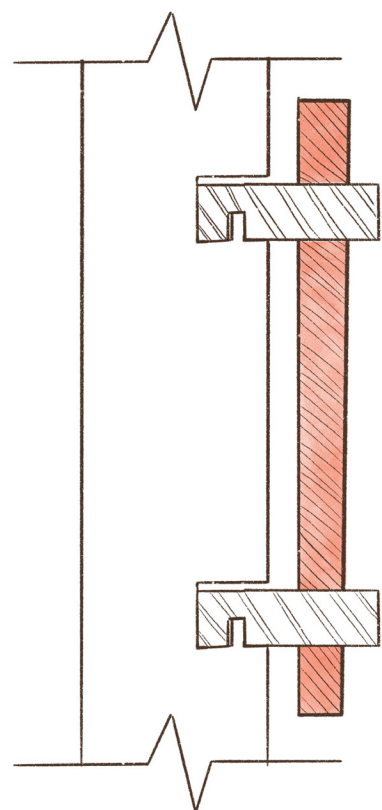

SECTIONAL DETAIL

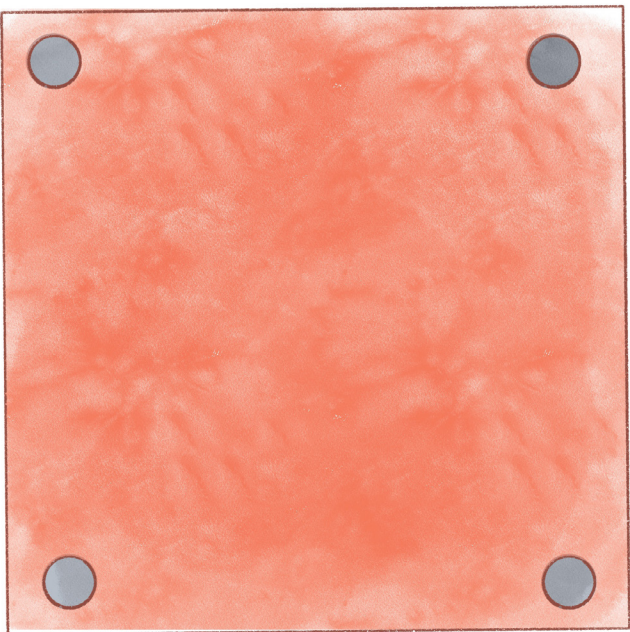

FRONT ELEVATION

DRAWINGS

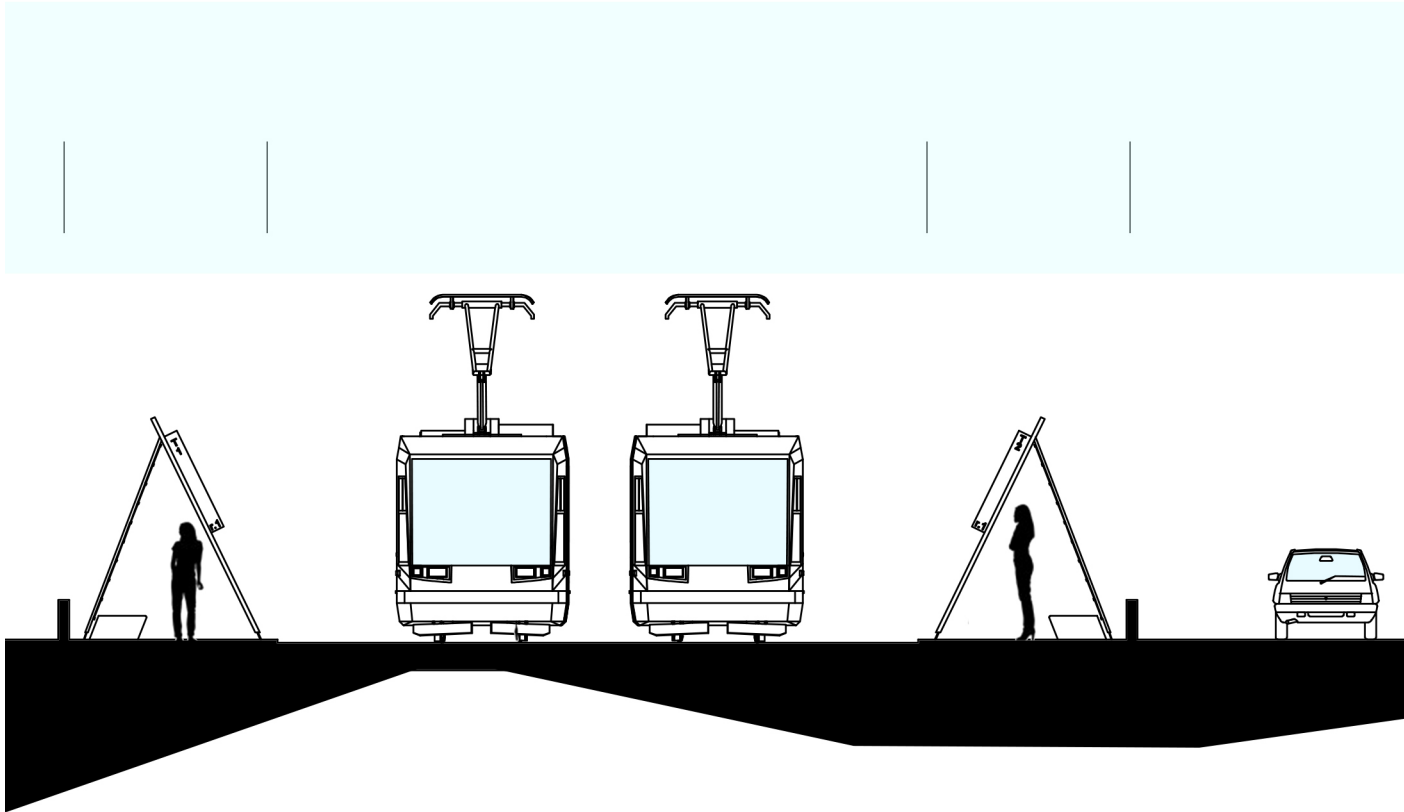

SECTION 1:100

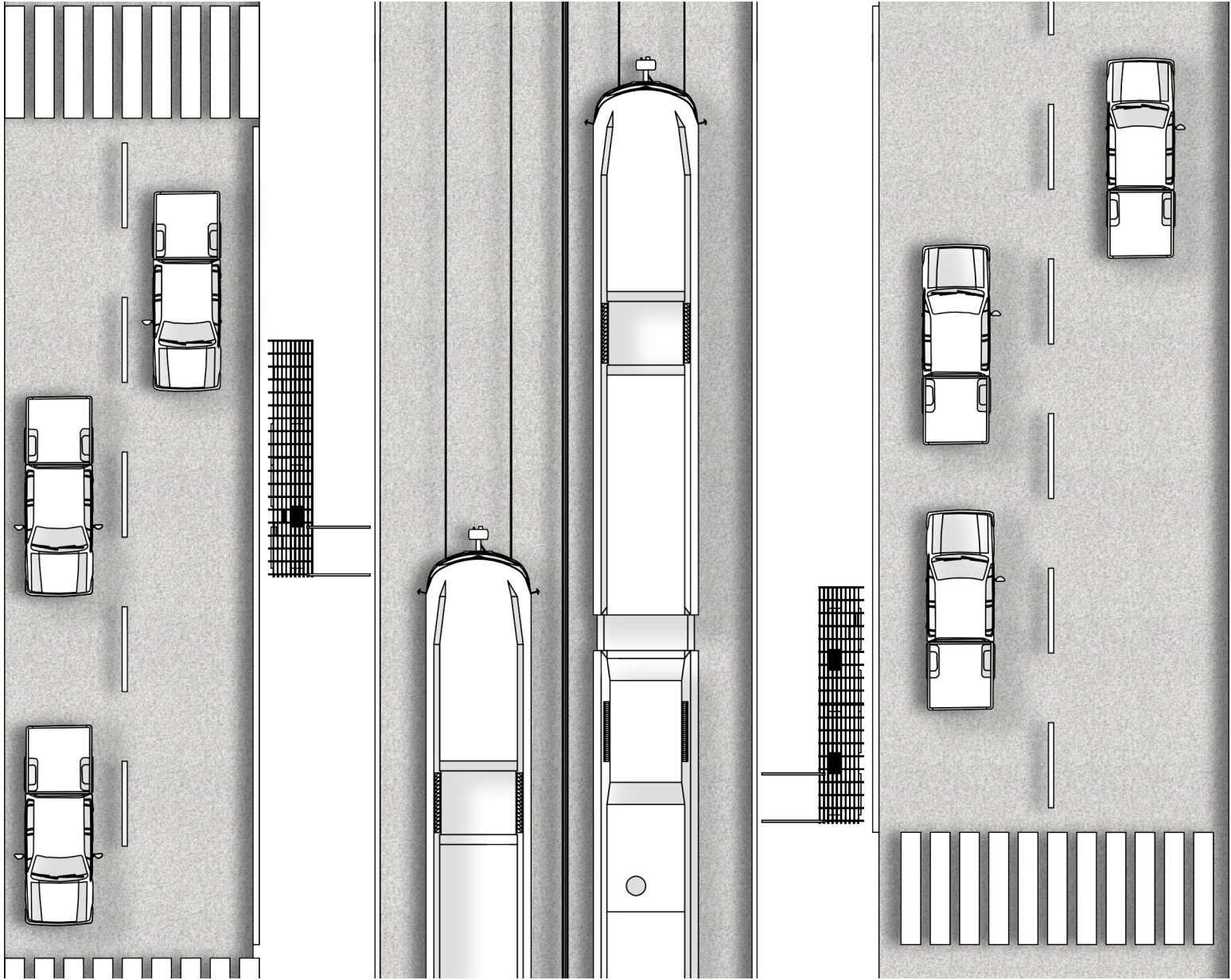

FLOOR PLAN 1:100

STREET VIEW

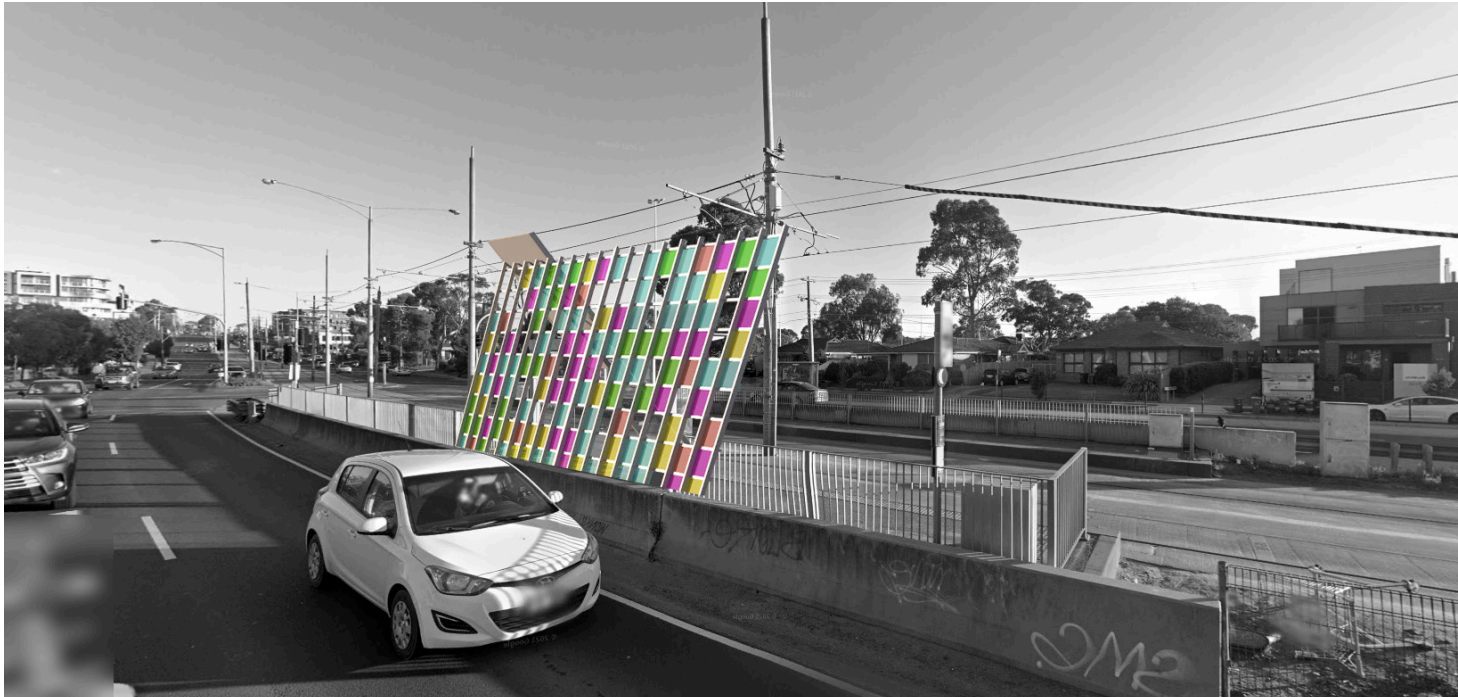

MODEL IMAGES

