

PottersField

Ali Azamy + Leelee Chea + Jean Marc Tang

Death is culturally associated with the final chance to celebrate life, but within the typology of the Potter's field, this notion is lost. Not only the opportunity for society to mourn and celebrate the lives of the deceased but the memories and stories associated with an individual are forgotten.

Hart Island Potter's Field has recently faced media backlash due to their handling of the Covid-19 burials, despite their century long history of operation. The souls that rest within the site were not treated with the same level of respect as those who had the opportunity to be celebrated privately. In addition to dehumanizing and hiding individual tragedies, Hart Island obscures these systemic failings. The tribulation of human condition features in these narratives due to social-economic injustices. Those unable to arrange a private funeral, unaware of what "The City Cemetery" entails, or disconnected, have found themselves on the island. To reclaim the lost from erasure is to confront the overlooked trauma inherent in a hyper dense city.

Our proposal aims to dignify the ill-fated events occurring on Hart Island through re-establishing an intimate human connection between the living and the deceased, expanding upon the impermanence of life and the beauty of time. A pedagogical notion of human contact emphasises the capacity of these relationships and instills empathy in those who reside in Hart Island. Burial trenches were hence taken to echo the capitalistic Manhattan Grid, as the souls of Hart island had lived by this urbanistic hegemony, and ironically had their death treated by the very same social condition.

Everyone is forgotten at some point in time, but we need to treat those in Potter's fields with respect and dignity to acknowledge these events through a collective consciousness.

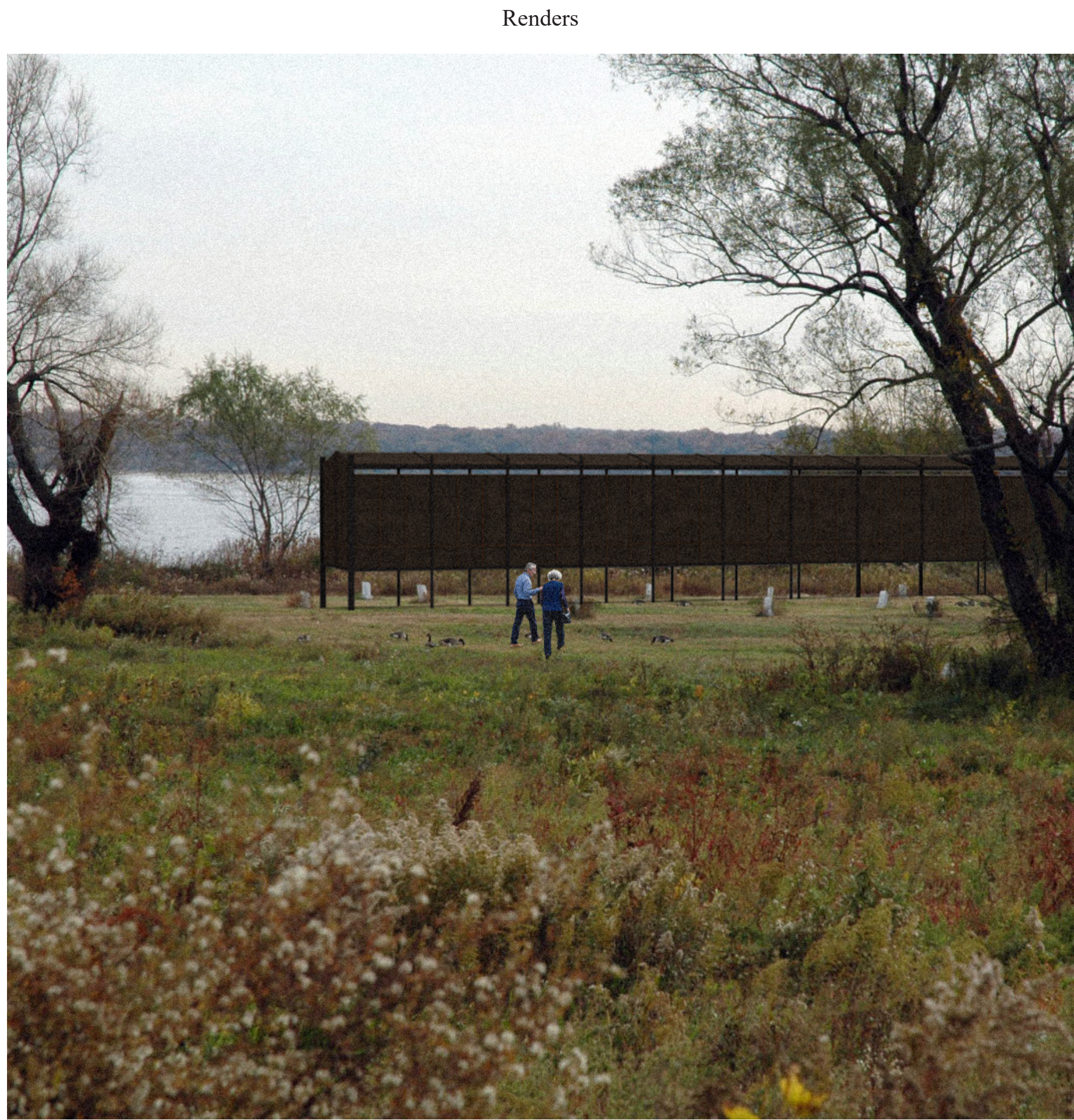

Hero Shot 01



Hero Shot 02

Masterplan

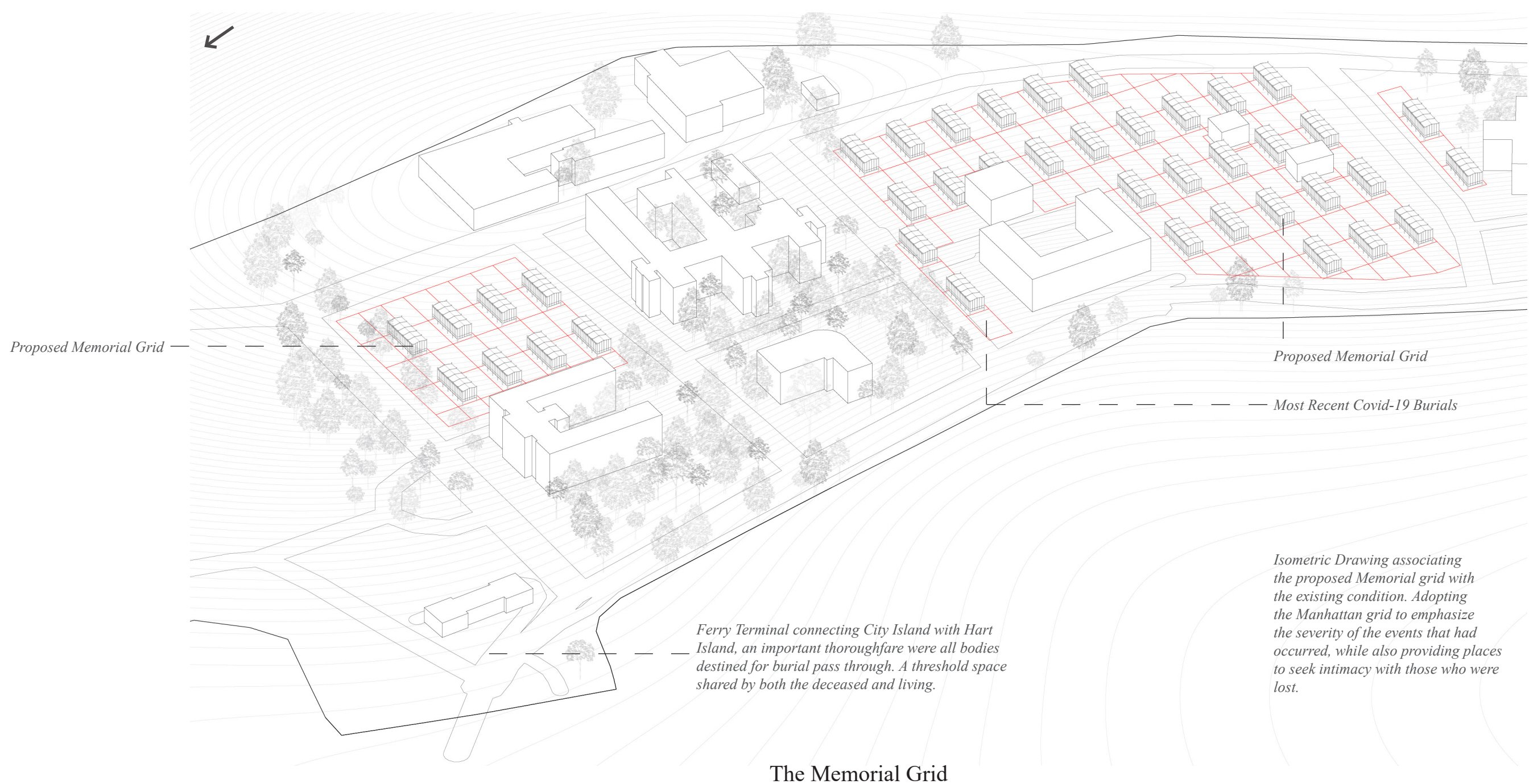
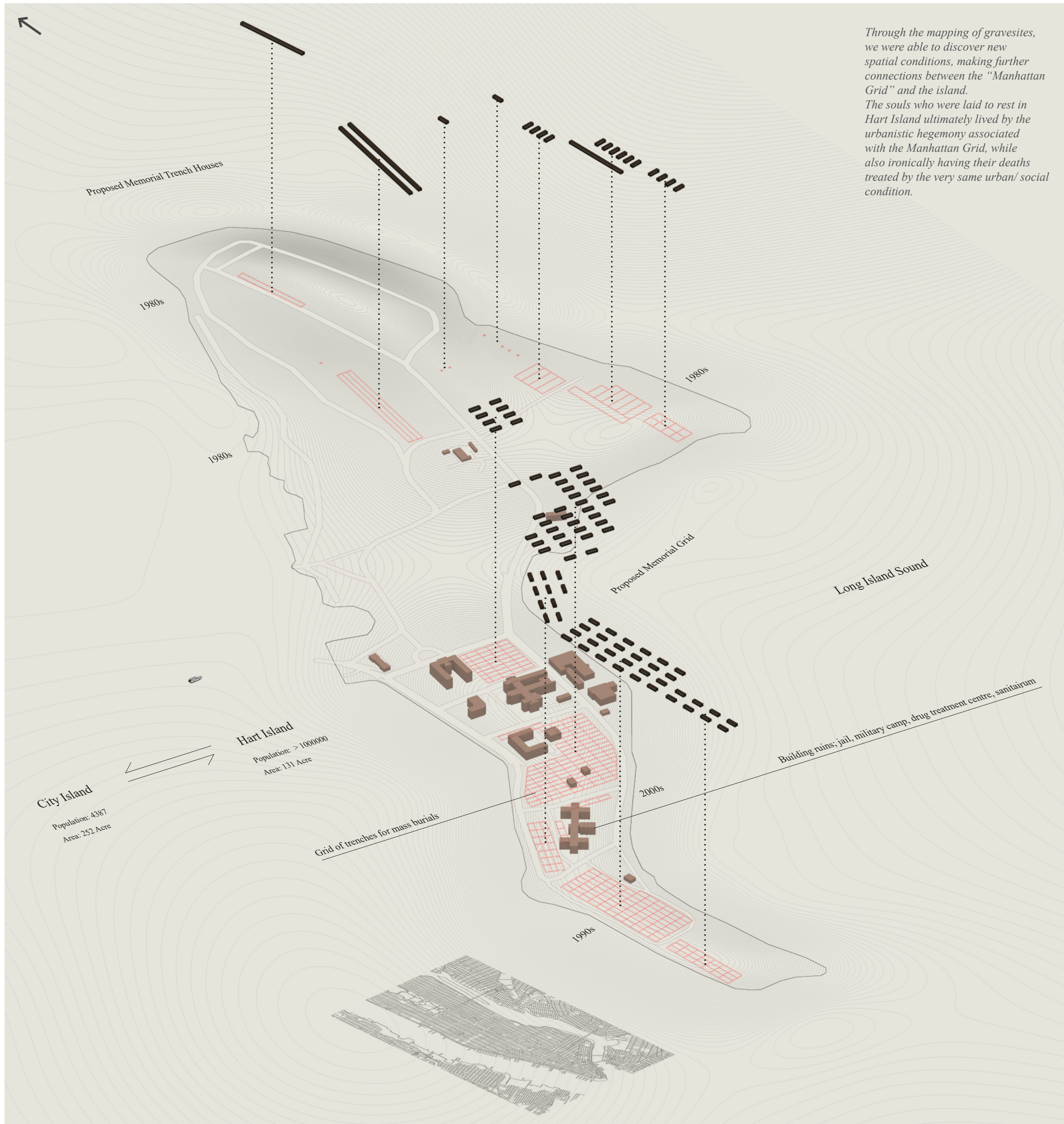

The Memorial Grid



The Isolated Trench

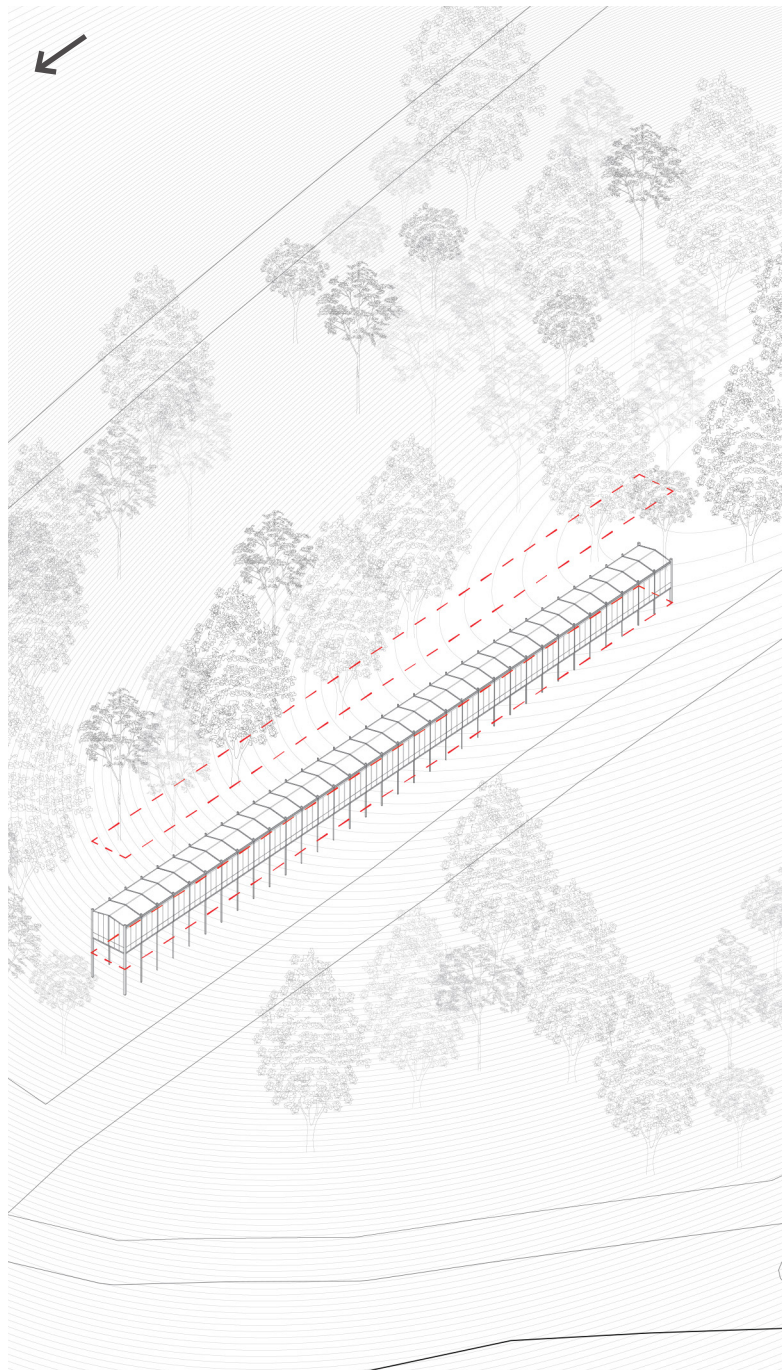

The Northernmost/ highest point of the island

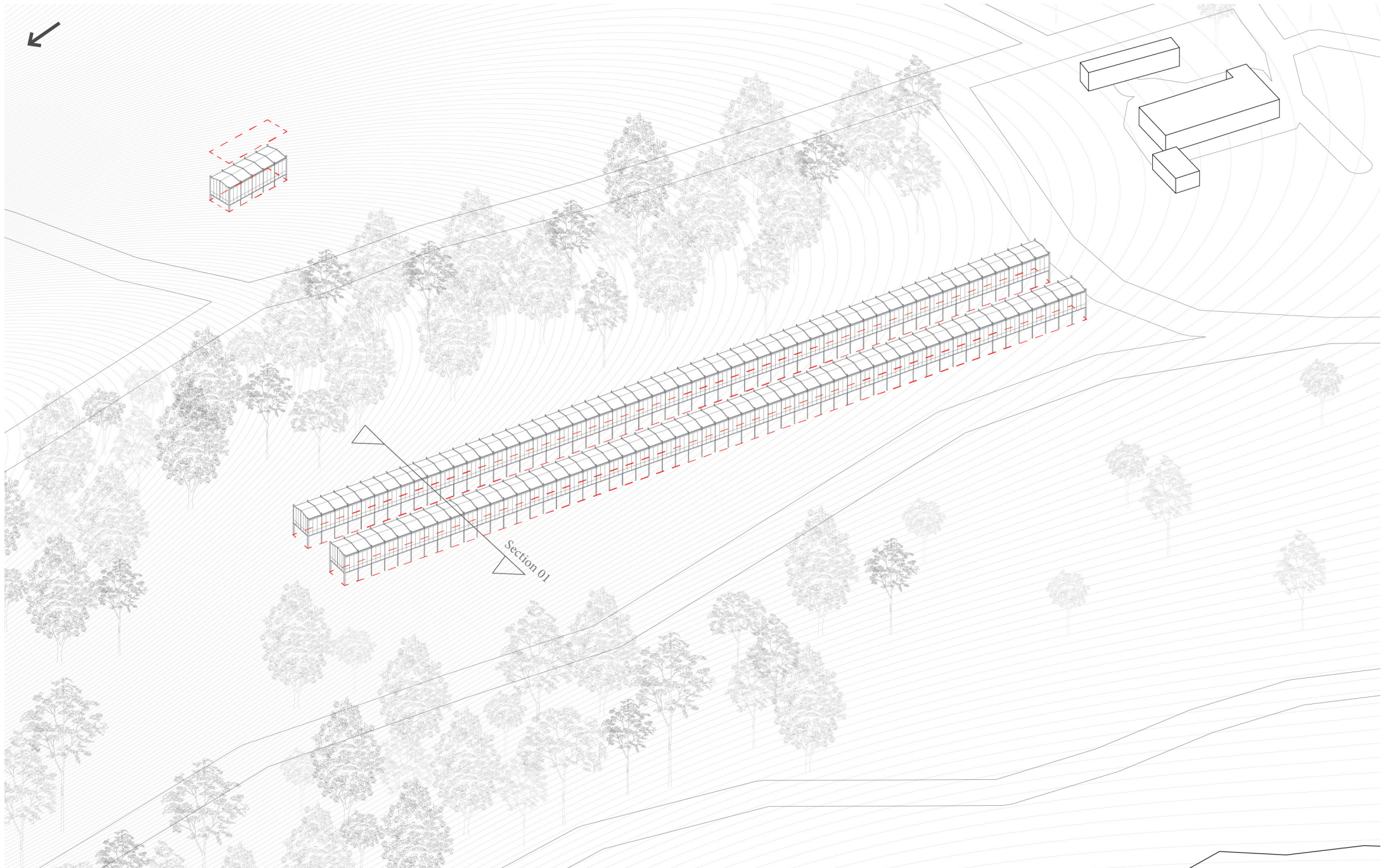

With Deriving our interventions organisaion based on mapping out gravesites, there was the discovery of several linear/ isolated trenches. With this we aimed to amplify the linear connections between the visitor, memorial and the deceased.

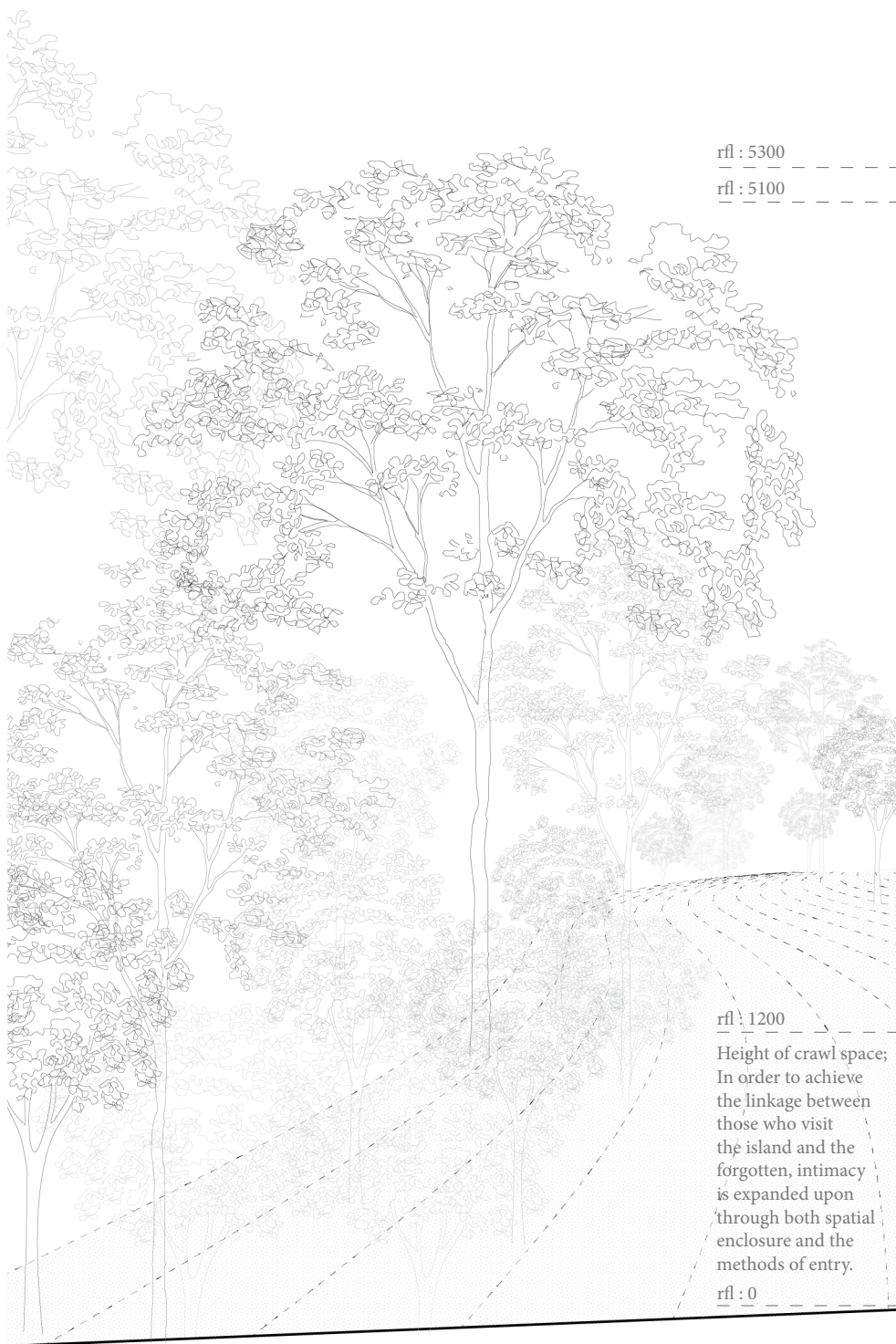

rfi : 1200
Height of crawl space;
In order to achieve
the linkage between
those who visit
the island and the
forgotten, intimacy
is expanded upon
through both spatial
enclosure and the
methods of entry.
rfi : 0

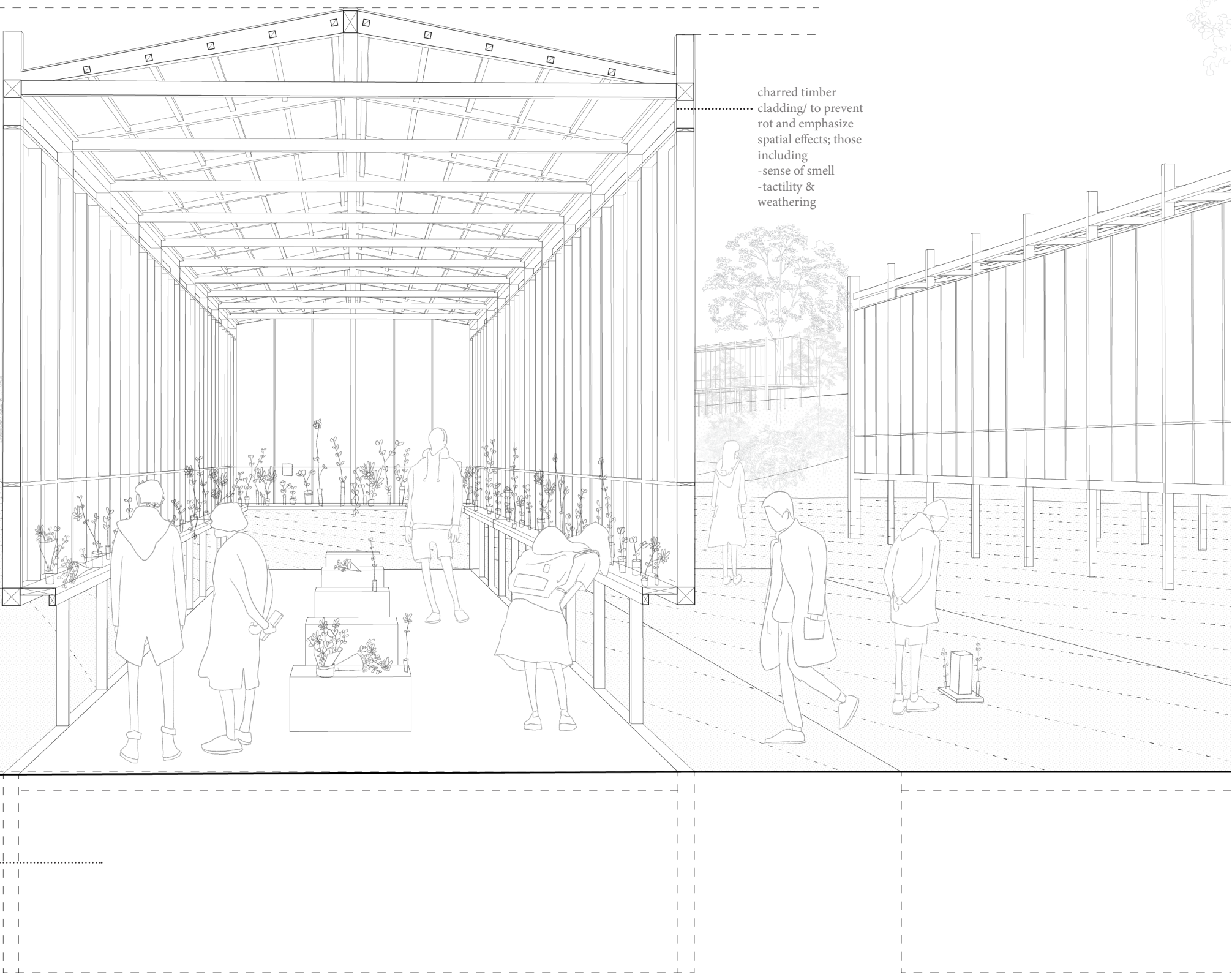

This drawing is a representation of internal conditions within the block pavilions, we propose that an intimate “physical” connection can be explored through architecture, one that’s capable of emphasizing ephemeral connections instilling empathy for those who reside in the Island.

Resting place of the
deceased/
Trench Grave
4.7m W
2.5m D

Section 01 : Not to Scale





Sequence of Spatial Experience



The “Palimpsest” Trench

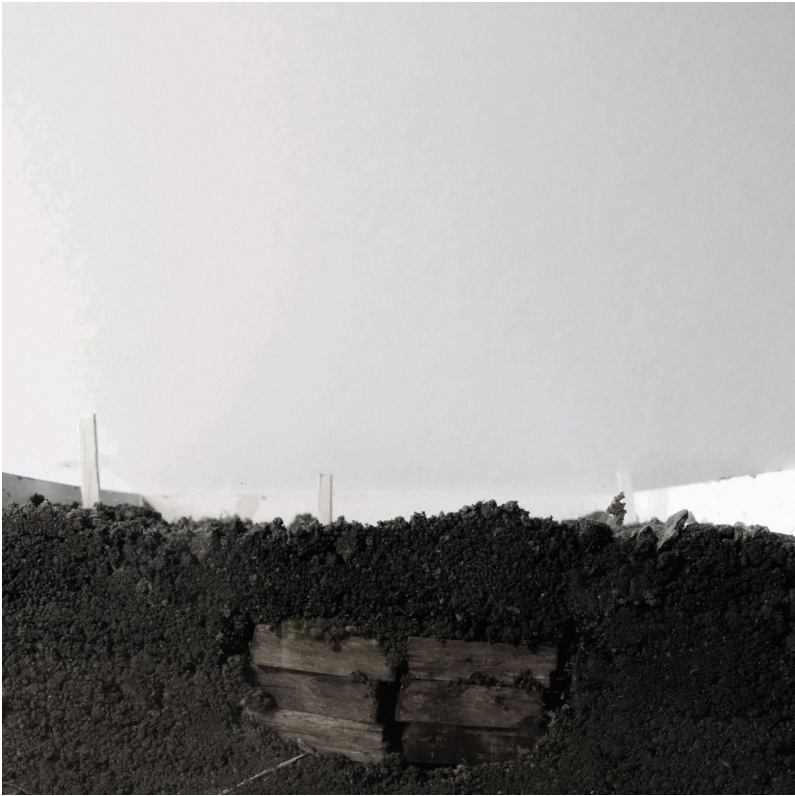

The Inconspicuous Burial



The Reclamation



The Spatial Severity embedded within the Grid
“Monument”



The Spatial Severity of the Trench
“Ideological and Physical experience”

