



Danish National Bank, Copenhagen, Arne Jacobsen

DULUX STUDY TOUR 2019 REPORT PHILLIP NIELSEN

It has been exactly one month since I landed back in Australia after the Dulux Study Tour and it has proven difficult to talk to people about the experience because I'm still coming to terms with it all myself.

Boarding the first flight of the tour there is no way you can imagine the immensity of the next few weeks, the friendships that are about to form, the tears, the laughs, all the food and yeah - architecture.

Since establishing our studio two years ago, the Dulux Study Tour was the first time I had been separated from the practice for more than a weekend... and even weekends had become a luxury.

When you're buried so deep in establishing a design studio and business it is hard to take a step back and contemplate how things could be run differently.

The opportunity afforded to me as a recipient of the tour gave me access to numerous practices and the chance to observe how they have grappled with their own complexities.

In the aftermath there have been two really strong themes that my thoughts keep bringing me back to.

The first is a feeling that all of the reasons we set up our studio are valid and that we're heading in the right direction. The second is that it's time to make time - for life, for research, for boundaries, for change.

Rather than provide an as-it-happened summary of what we saw in each city, I'm going to write about the places and people who influenced these two themes.

I am so grateful for the opportunity afforded to me by the Australian Institute of Architects and Dulux. The tour also gave me the chance to travel to Porto and Italy for the first time and attend the London Festival of Architecture. I've included a few pics from my post DST travels.

Thanks also to Alix, Ben, Carly and Jen - you're all amazing and I'm so glad we were able to share this experience together and to consider each of you as a friend.



L-R Carly McMahon, Alix Smith, Jennifer McMaster, Phillip Nielsen, Ben Peake

IMPRESSION 01

IT'S TIME TO MAKE TIME

Make time for yourself
Make time for your team
Make time for projects
Make time for research
Make time for community

I started working in architecture as a third year student in 2006 for a small architecture studio run by Dulux Study Tour Alumni Yuri Dillon. Since that time I worked in a variety of practices with varying models of business and design. I also experienced the complexity of studios reflecting on how they could work smarter, introducing new systems, strategies and software.

When we set out to start a studio in rural Australia it didn't cross my mind that within two years we'd need to do the same thing. Enter the Dulux Study Tour...

The DST was the first time I had taken more than a weekend off from Regional Design Service. Like many designers the boundary between life and architecture is extremely blurred - running your own studio only makes this more obscure.

On the tour I was struck by the experiences of other studios that has struggled with the same issues and had come out the other side stronger and happier.

Studio David Thulstrup, Copenhagen with David Thulstrup and Georgie Prittie

I'll admit - I'm a fan girl for David Thulstrup and when I learnt we were travelling to Copenhagen his studio was on the top of my list.

Entering the studio I didn't expect that we would meet David or that he would openly talk to us about the struggles of growing from a one man studio - 'working for the love of it' - into a 20+ architecture, interiors and design practice ten years later.

Struggling to keep up with running a practice, writing proposals, signing contracts, managing the team and designing, David began working with a business coach.

From this point the studio employed a CEO to on more of the business side of design allowing David to reconnect with his passion and the reason he started the studio - design.

Another strategy they employed was to assign particular sectors to days of the week. For instance, Mondays are for business, Tuesday for residential, Wednesdays for commercial, Thursdays for product and Fridays for hospitality projects. The structure affords each team member, David included, the ability to work to a set framework each week.

ARX Portugal, Lisbon with José Mateus

Closing out the tour we met with José Mateus who is a co-director of ARX Portugal with his brother as well as Director of the Trienal de Lisboa.

Over the course of our visit José discussed the history of the practice including its near demise in the fallout of the global financial crisis and the need to completely rebuild their business. With almost no work they decided to become more involved with the academic and institutional side of the industry while developing new work with investors in lieu of government work.

Diversifying the work of the studio to roles of advocacy and education also influenced the studios decision to introduce a four day work week for their team. Whilst highlighting the positive impact on their teams lives, José uses his 'day off' to work from home designing the studios single house projects at his own pace.

Walking out of this visit I spoke with my partner Aaron back in Australia about introducing a four day work week from July which we are implementing currently.

6a Architects, London with Karolina Sznajder and Alex Butterworth

In contrast with creating defined structure for the work week we visited 6a Architects who introduced us to their design approach that is obsessed with the context of each project.

During their presentation we were introduced to the 'Modernist' city of Milton Keynes which was built in the 1960's for 250,000 people. Through extensive research the design team uncovered so much information that would go on to influence the design of an extension to the cities gallery. This approach to design reminded me of my obsession with Peter Eisenman as a student and has inspired me to make time to explore the context of place in our future projects.

IMPRESSION 01
IT'S TIME TO
MAKE TIME



Tour of the Studio David Thulstrup sample library



ARX Portugal visit with (L-R) Carly McMahon, Christina de Mendonça (Embaixada) and José Mateus.



6a Architects visit with (L-R) Jennifer McMaster (Trias), Karolina Sznajder and Alex Butterworth



Studio David Thulstrup



MK Gallery interior with curtains inspired by colours from the 1960's Milton Keynes marketing collateral.

IMPRESSION 02

HEADING IN THE RIGHT DIRECTION

Design is about you

Design is about people

Design is the world around you

Meeting so many studios over a short period of time kicks the brain in to overdrive. So much of our profession is more than design - we work in business development, marketing, community development, design advocacy, education, politics and more. We wear many hats and it is rare for any project to have a singular narrative.

Regional Design Service was established as a studio that would instigate a conversation between architecture and the general public in regional and rural Australia. Our aim is to create a dialogue about design, its value, what it is and how it improves life. We volunteer with community groups, undertake pro-bono work and facilitate a variety of public events about design. All of this is on top of our project work that funds our not-for-profit agenda.

As a young professional forging down an unfamiliar path there are always those demons in your mind that question if we are actually doing the right thing? Is it valuable? Will it improve peoples lives? During the tour I became overwhelmed by a sense of comfort and reassurance that our studio is headed in the right direction and to forge forward.

Democratic Design Denmark

On our first official day of the tour we had the pleasure of an eight hour guided cycle tour through various neighbourhoods of Copenhagen by Alice Lempel Søndergaard.

Over the course of the day Alice took us to so many projects and gave us an in depth insight in to design teams pursuit to deliver the clients brief but also create an outcome that give something back to the public. An act of generosity that benefits everyone from the client, the public and the city at large. Walking away from this tour I contemplated how we pursue a similar outcome for our rural clients.

During our studio visits to Tranberg Lundgaard, Gehl, Leth + Gori and Cobe the narrative of pursuing projects that could give back continued.

Tranberg Lundgaard kicked off the day taking us through their portfolio. Through the design of the Royal

Danish Playhouse the studio approached the building as a chance to resolve the lack of public space in the area by relocating nearby street parking into an underground carpark, introducing flood mitigation parklands where carparks once existing and the creation of a new waterfront plaza. Their original remit was to design a new playhouse - simple.

Later in the day we stumbled down a residential street into a former bakery that has been converted into a shopfront architecture gallery and studio for Leth + Gori. As we heard more about the practice from Uffe Leth we also heard about the gentrification of the area and how former shopfronts had been converted into housing. They believed this pattern of development was destroying the character of the streetscape and that their shopfront gallery could be a catalyst to change the trend and recreate the dynamic neighbourhood character of the past.

Our studio in Corowa is located in a shopfront on the main street with the aim of displaying how we work. Community members regularly drop in to see what we are working on and we trying to engage their curiosity as much as possible. Our long term aim is the move to a larger shopfront space which will include a gallery space and space for community events and workshops about design. Visiting Leth + Gori has given us the confidence to pursue this further.

The Design Museum

Arriving in London we visited The Design Museum and were fortunate enough to have Museum Director Alice Black give us insight into the building but also the history of the museum. The vision of the museum is to create 'a world where everyone values design...' and to '...make the impact of design visible.'

Their permanent exhibition 'Designer Maker User' showcases the role of design from everyday objects through to weapons, cities and the world at large.

Knowing little about the vision of the museum I was comforted to know that our design talks in Corowa approach design from a similar perspective. Exploring the museum and hearing from Alice has given me the confidence to continue working with our community to better understand design and it's place in our lives.

IMPRESSION 02 HEADING IN THE RIGHT DIRECTION



An introduction to the 'democratic' Danish Architecture with Alice Lempel Sondergaard (Be Copenhagen)



The crew with Uffe Leth (Leth + Gori) in their shopfront gallery / architecture studio.



What is 'good' design? Installation from the 'Designer Maker User' Exhibition at The Design Museum, London



Alice Black, Director of The Design Museum, London.



'Gifted by design' public space in front of the Royal Danish Playhouse by Tranberg and Lundgaard

COPENHAGEN

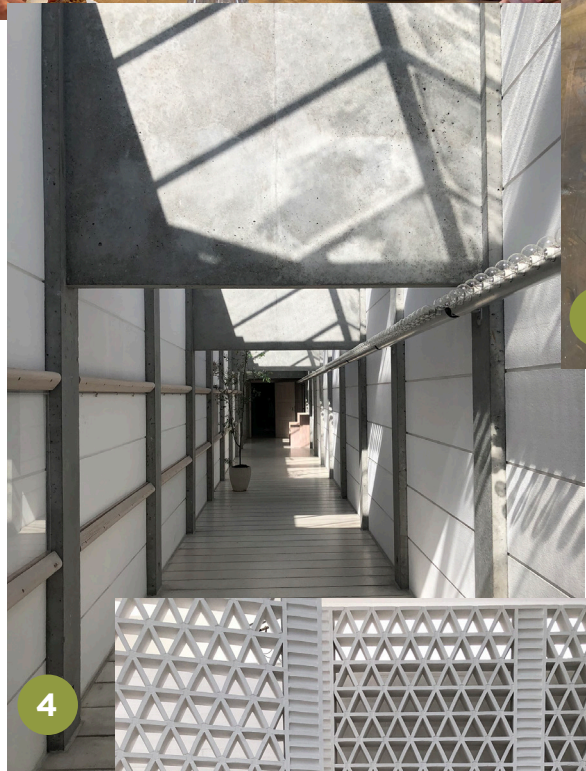
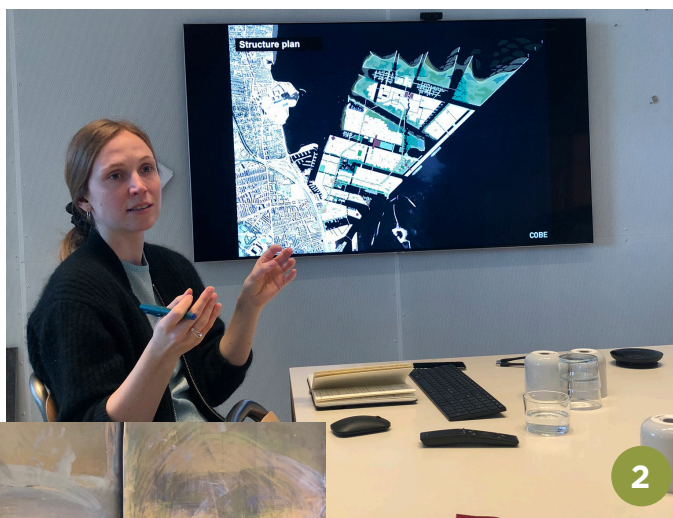

1. Lunch at Gehl, 2. Cobe Studio presentation by Karoline Richardt Beck. 3. Touch everything... Jen! 4. Bagsværd Church tour with Jan Utzon. 5. Bagsværd Church, Jørn Utzon. 6. Konditaget Lüders playground on top of a carpark.

LONDON

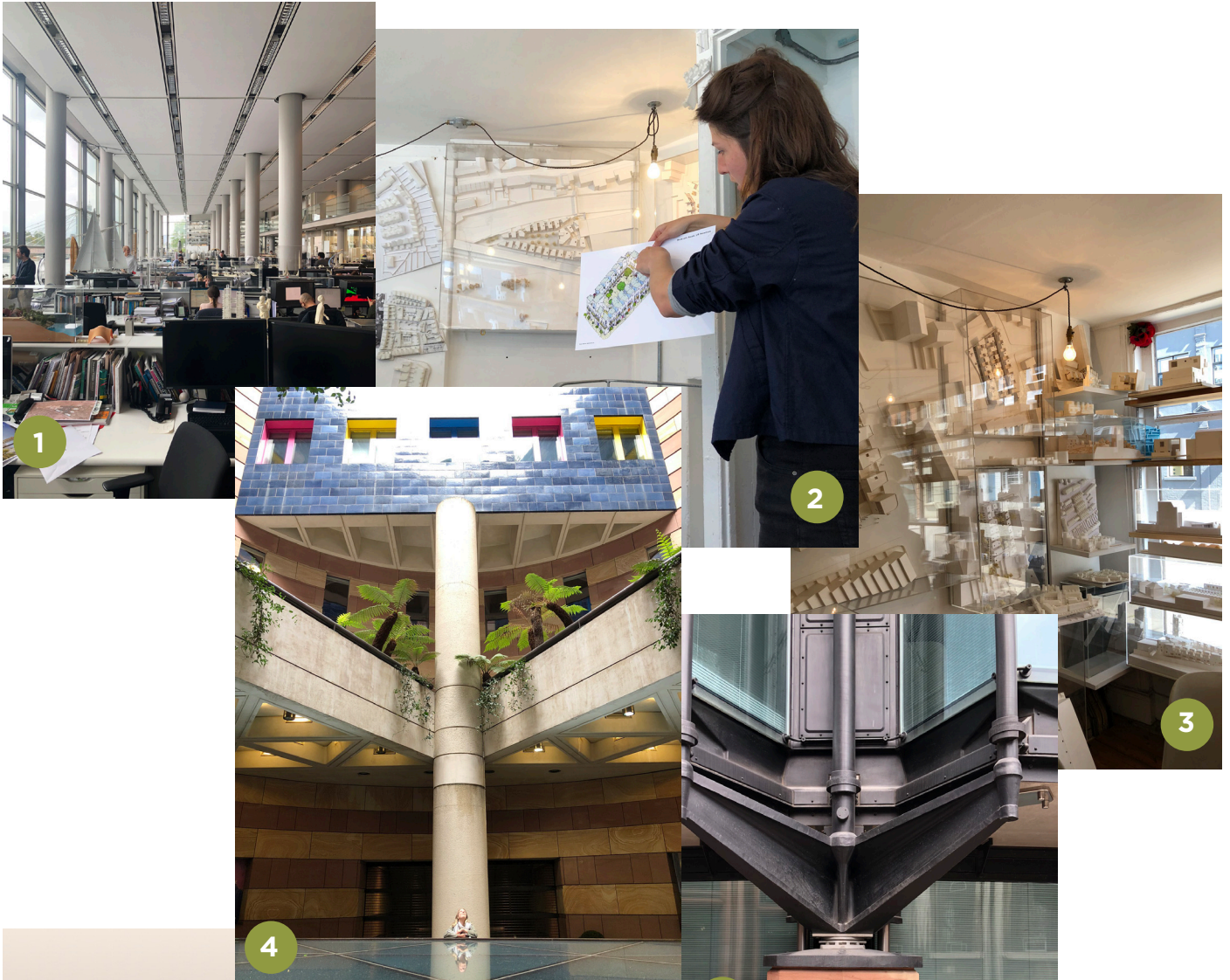

Busted getting the names of all the organic materials in the @fosterandpartners sample library for our country practice

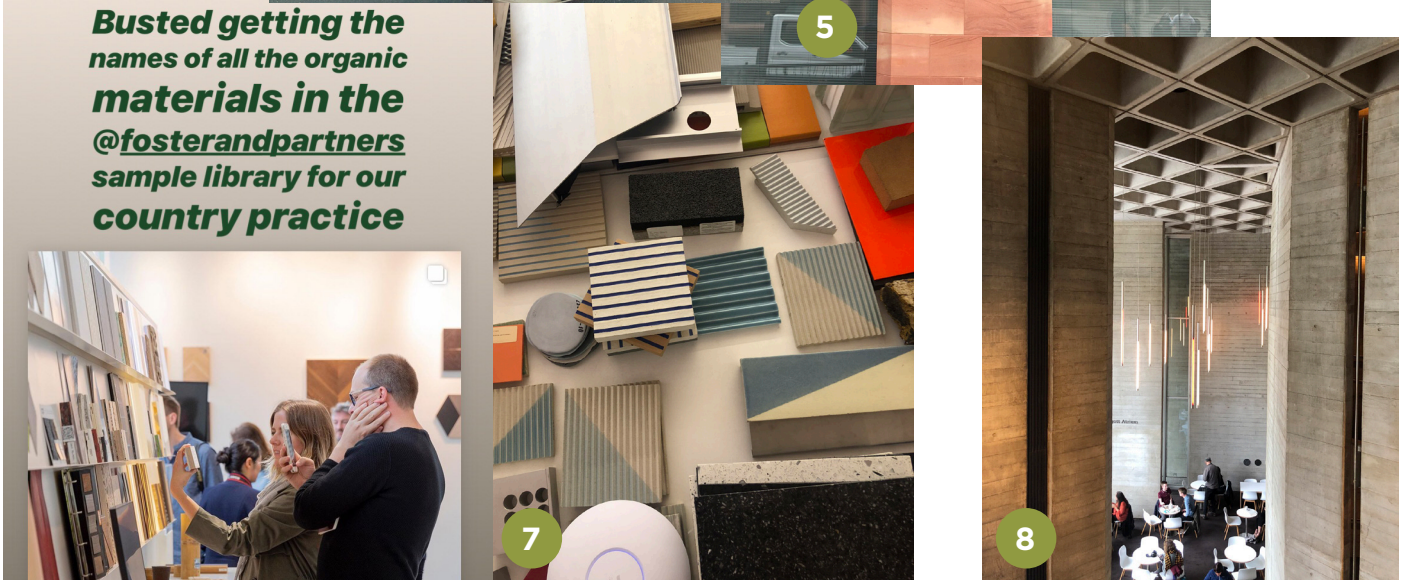

6

@fosterandpartners

@INSTITUTE_ARCHITECTS_AUS
@DUIJIXAUS
@ARCHITECTURE_AU
@alixmyth

7

8

1. Foster + Partners 2. Peter Barber Architect presentation by Alice Brownfield. 3. Peter Barber Architects shopfront with years of models. 4. No. 1 Poultry, James Stirling (model - Alix Smith). 5. Bracken House designed by Sir Albert Richardson, 1955. 6. Busted photographing samples in the Foster Library. 7. AL_A material prototypes. 8. National Theatre

LISBON

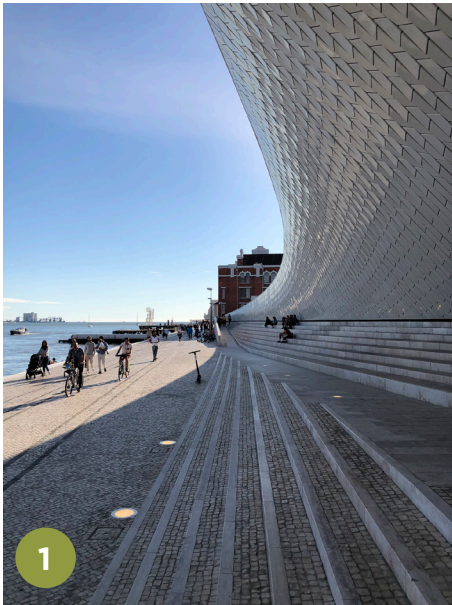

1. MAAT by AL_A 2. 'Touch everything, Crackers.' Devine. 3. Palacio Ciado for dinner. 4. Thalia Theatre Renovation 5. Portugal Pavilion, Julius Caesar... I mean Álvaro Siza. 6. #scaleofflinda, EDP Headquarters, Aires Mateus 7. Bak Gordon studio visit.

POST DST2019 PORTO



FALA Studio Visit



Paulo Moreira Studio Visit

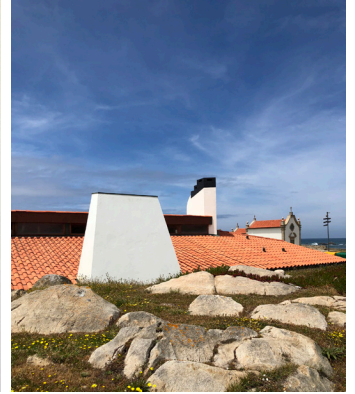

Boa Nova Tea House

ROME

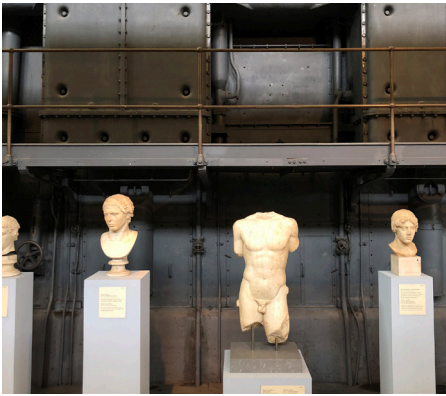

Museu Monte Martini



Pezo von Ellrichshausen @ MAXXI

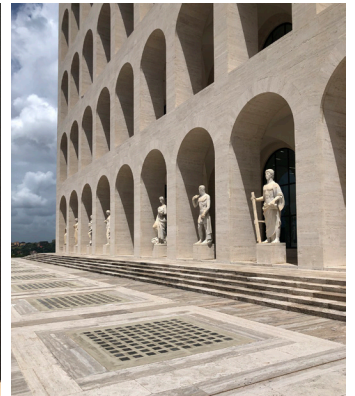

Palazzo della Civiltà Italiana

BOLOGNA



Gavina Showroom, Carlo Scarpa



Pavillon de l'Esprit Nouveau, Le Corbusier

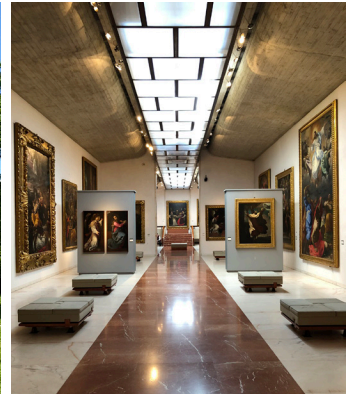

Pinacoteca Nazionale,
Leone Pancaldi



Bologna Shoah Memorial, SET
Architects



Fiera District, Kenzo Tange



Bologna, 40kms of porticos

**POST DST2019
MODENA / MILAN**



San Cataldo Cemetery, Aldo Rossi



Fondazione Giangiacomo Feltrinelli, Herzog & de Mueron

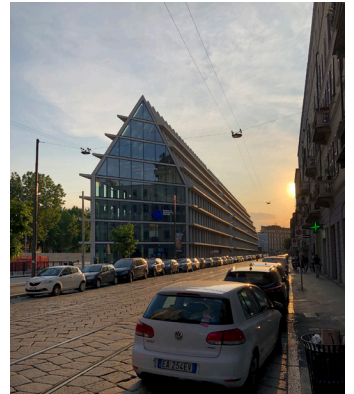

LONDON



15 Clerkenwell Close



15 Clerkenwell Close tour with Amin Taha

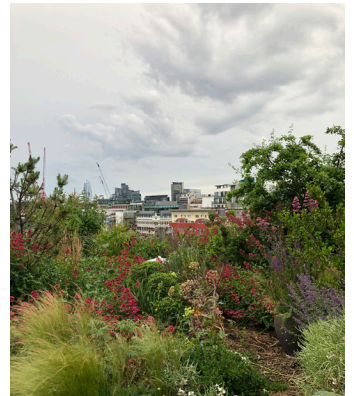

15 Clerkenwell Close rooftop garden



The Sackler Courtyard, V+A, Amanda Levete Architects



'Qamt' Bench by Elias and Yousef Anastas @ V+A for London Architecture Festival



Post-Modern Design at the V+A

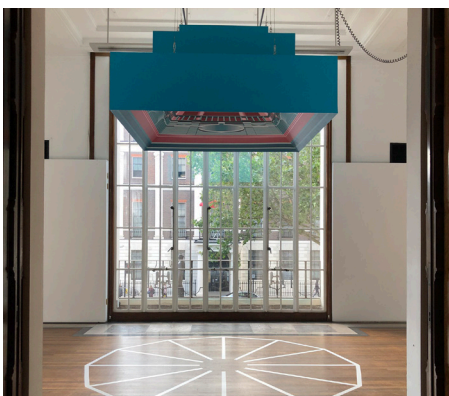

Above and Beyond by Etcetera Studio



V+A Museum of Childhood, Caruso St John



London Aquatics Centre ZHA

DULUX STUDY TOUR 2019 REPORT PHILLIP NIELSEN



DST2019 Band photo

DULUX STUDY TOUR 2019 RECIPIENTS

Ben Peake
Carly McMahon
Jennifer McMaster
Alix Smith
Phillip Nielsen

DULUX REPRESENTATIVES

Caroline Field
Anurita Kapur

AUSTRALIAN INSTITUTE OF ARCHITECT REPRESENTATIVE

Mai Huynh

ARCHITECTURE MEDIA REPRESENTATIVE

Linda Cheng

TOUR GUIDES

Copenhagen

Alice Lempel Sondergaard, Be Copenhagen

London

David Garrard, Architectural Dialogue

Lisbon

Rodrigo Lima, Cultour

REGIONAL DESIGN SERVICE

127 Sanger Street
Corowa, NSW, 2646
Australia
+61 02 6033 0717

hello@regionaldesignservice.com
regionaldesignservice.com

ABN: 95618132684

Nominated Architect
Phillip Nielsen
NSW Reg: 10322
QLD Reg: 5332
VIC Reg: 19672

STUDIO VISITS

Copenhagen

Tranberg and Lundgaard
Gehl
Leth and Gori
Cobe
Studio David Thulstrup

London

Peter Barber
6A Architects
AL_A
Rogers Stirk Harbour + Partners
Foster + Partners
HASSELL
AHMM

Lisbon

Second Home
Embaixada
Bak Gordon
ARX Portugal