

TASMANIAN ARCHITECTURE AWARDS 2021



National
Architecture
Awards



Australian
Institute of
Architects

President's Message



In the words of Juhani Pallasmaa: 'architecture is a mode of philosophising through the means of space, structure, matter, gravity and light. Profound architecture does not merely beautify the settings of dwelling, great buildings articulate the experiences of our existence.'

That's a lot of pressure and responsibility, especially when you put it into the context of landscape, townscape, heritage and community, while simultaneously moving towards a sustainable, diverse and inclusive future.

In preparing a project for the awards, this responsibility is tested. You go through

a self-effacing process of re-evaluating what you've done, acknowledging the possibility of appropriation to some degree, the unexpected things you didn't consider or articulate, things that maybe you even thought which became embodied in your intuitive actions. Then, even more revealingly, you share those thoughts and processes by presenting to a jury and an audience of peers, which challenges your motivations, actions and choices.

Part of the Australian Institute of Architects' current agenda is to prepare a vision statement which speaks to the present and future membership, with an objective of providing inspiration and a professional position to live up to.

This extract from Foster & Partners is an example:

'We are driven by the pursuit of quality — a belief that the quality of our surroundings directly influences the quality of our lives — that architecture is generated by the needs of people and these are spiritual as well as material.'

And this, from global engineering firm ARUP, is both an outward position and one of self-growth:

'to enhance prosperity and quality of life... to deliver real value... to have the freedom to be creative and to learn.'

If you come at this from the point of view of an architect, there may be a different weight and meaning on words like prosperity and value; and therein lies some of the difficulty in trying to describe in a few words the aspirations of a whole profession.

To articulate a vision that makes sense for the public and ourselves may not be easy, but more important is providing evidence that what is said can be lived up to — here among the projects showcased in the awards program is an abundance of such evidence.

Craig Rosevear RAIA
President, Tasmanian Chapter
Australian Institute of Architects

Partners

The Tasmanian Chapter of the Australian Institute of Architects (the Institute) thanks our generous partners for supporting the 2021 Tasmanian Architecture Awards.

To find an architect and to view award-winning architecture, visit www.findanarchitect.com.au

Principal Partner



Major National Partner



National Corporate Partners



National Supporting Partners



National Insurance Partner



National Media Partner



State Partners



In-kind Partners



Cover image:
MOSS 25
Circa Morris-Nunn Chua Architects
Photographer - Adam Gibson

President's Prize 2021

Gregory Luttrell RAIA

and Jonathan Pyefinch RAIA

LUTTRELL PYEFINCH ARCHITECTS



The 2021 President's Prize recognises the quiet, thoughtful and considered contribution to the architecture profession made by the leaders of Luttrell Pyefinch Architects.

From their time at University, they have been impressive characters: talented, thoughtful, driven and committed, and tempered by humility and humour. Over the years (25 of them in business together), their practice has primarily focused on educational and community projects that embody collaborative, socially responsible, ethical and human architecture. Founded on the belief that great design should be accessible to all, and without seeking accolades, their folio of work demonstrates their considerable skill in maximising design opportunities from tight budgets and programs. It is remarkable that they have completed over 450 educational projects across Tasmania during their years in practice.

Their longstanding relationships with clients, builders and consultants is admirable and a testament to their friendly, respectful and people-focused approach. In collaborating with clients, Greg and Jonathan are always thorough, diligent and reliable, and care about their work, not just in terms of the design, but how it meets the needs of the client. They operate with humility but also with an immense pride in the quality of their work. They cooperate with builders in a firm but fair manner that ensures a project is successful for all parties. This has earned them the highest respect from members of the construction industry.

They share their love of architecture with the wider community and have been the catalysts for many an Institute initiative in an effort to share architecture with the public, across awards programs, CPD and Open House Hobart.

Their energy and passion for the work they create, and for the people they work with and for, is inspiring. Honest, caring and generous, their combined skill, knowledge and wit has allowed their practice to thrive. Congratulations, Greg and Jonathan, on being awarded the 2021 President's Prize.

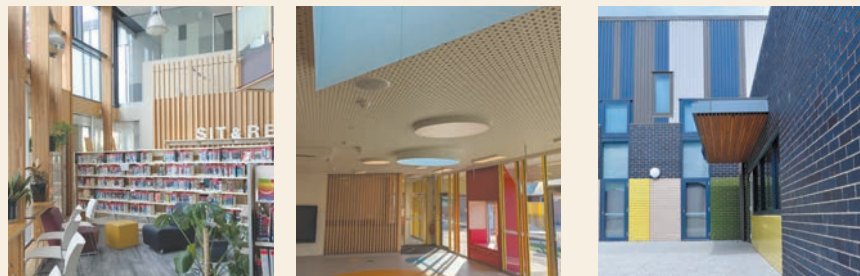

L-R: Sacred Heart College, Northern Christian School, Emmanuel Christian School



A Message from BlueScope

As Principal Corporate Partner, BlueScope has had the honour of supporting the Australian Institute of Architect's efforts in championing inspiring, clever and sustainable architecture for the last 36 years.

We know that architects, designers and specifiers constantly juggle their creative inspiration with commercial realities – that the nature of your profession is to constantly problem-solve.

What you may not know as architects is that BlueScope takes pride in supporting and assisting architects in this endeavour. We have the people, the products and resources to help you overcome your creative challenges and together achieve amazing things.

Our team of specification account managers is always on hand to connect

you to a vast amount of BlueScope expert steel resources across a diverse range of fields – in general, or with as much detail as required.

Another way we are supporting the needs of the industry is through our free-of-charge product specification website portal – SteelSelect®.

SteelSelect® provides comprehensive tools, resources and information to make researching and selecting steel products from major steel profile and panel suppliers faster, easier and more accurate.

If you'd like to learn more about our building products visit steelselect.com.au. Need help with a challenge? Just call 1800 753 658 and ask for your local specification account manager.



Discover the subtle art of standing out.

COLORBOND® steel Matt is a highly attractive and versatile design material that utilises innovative paint technology to diffuse light for an elegantly soft, textured appearance. Available in a range of neutral colours, it can be contrasted with other COLORBOND® steel products to create sophisticated palettes for commercial, industrial or residential projects.

Visit Steelselect.com.au/COLORBONDsteelMatt or call 1800 064 384.



COLORBOND®, BlueScope and the BlueScope brand mark are registered trade marks of BlueScope Steel Limited.
© 2021 BlueScope Steel Limited ABN 16 000 011 058. All rights reserved.



The COLORBOND® Award for Steel Architecture

Cradle Mountain Visitor Centre

CUMULUS STUDIO

Balancing the pragmatics of creating an expansive, protective roof form with the poetics of the ethereal quality of the folded screened edges, Cumulus Studio's Cradle Mountain Visitor Centre frames an articulated landscape of paving and planting.

Dispersed across the site, three contrasting black pavilions provide places for public amenities, orientation/information, and bus pick up.

The mastery of the project lies in the articulation and placement of the series of sculptural forms that frame carefully orchestrated spaces that are both confident and projective, flexible and playful.

Fairbrother Construction | Builder
Playstreet | Landscape Consultant
Futago | Wayfinding and Signage
Alex Miles | Artist (Installation)
Aldanmark | Engineer
COVA | Services Consultant
Pitt & Sherry | Electrical Consultant
NVC Acoustics | Acoustic Consultant



Photographer - Rob Burnett

Tasmanian Architecture Jury

James Morrison RAIA, Jury chair
Paul Wakelam RAIA
Garth Ancher RAIA
Liz Walsh RAIA
Dr Helen Norrie, UTAS

SWT Blythe Student Prize Jury

Misho Vasiljevich RAIA
Stuart McKenzie Hall RAIA
Rachel Licht RAIA

Emerging Architect Prize Jury

Craig Rosevear RAIA
Felix Blackman RAIA
Pippa Jensen RAIA

2021 Tasmanian Architecture Awards Jurors



ALDANMARK
CONSULTING ENGINEERS

STRUCTURAL
HYDRAULIC
CIVIL
GEOTECHNICAL



Commercial Architecture

MOSS 25

CIRCA MORRIS-NUNN CHUA
ARCHITECTS

Keeping the original Georgian façade intact, the unobtrusive, limited rear extension manages to include twenty-one accommodation suites in this tight and sensitive urban environment.

New materials are juxtaposed boldly with the heritage fabric, while internal greenery, local timbers and handcrafted furniture locate the project in Tasmania.

The original rooms facing onto Salamanca Place and the tower to the rear bookend a central double-volume space. Free-standing pods differentiate an entrance area on the one end from a stairwell and sitting area on the other.

This is an impeccable example of repurposing disused city space to create a rich environment that contributes to a denser and vital city.

Vos Construction & Joinery | Builder
SMG | Project Manager
Pitt & Sherry | Building Surveyor
Behrakis Group | Developer
Aldanmark Engineers | Engineer

The Colin Philp Award for Commercial Architecture



Photographer - Adam Gibson

Chapter Award

Stoney Rise Wine

CUMULUS STUDIO

Stoney Rise cellar door is perched like a work of origami unfolding in the landscape.

Upon entry, the welcoming brick blade walls are enveloping. A single window to the west faces the grape vines, quietly connecting visitors to the wine-making process.

Brick has been used to form display shelving, creating continuity between indoor and outdoor spaces and defining the outdoor courtyard.

The sculptural form of the building creates a micro-climate that places the visitors in the sun and out of the wind, while providing an expansive panoramic view of the Tamar Valley.

Eustace Builders | Builder
A2 Kitchens & Joinery | Kitchen Joinery
Core Construction Management | Quantity Surveyor
Green Building Surveying | Building Surveyor
Rare Innovation | Structural Engineer
JMG | Electrical Consultant
JD Consulting | Waste Water
Southern Lighting | Lighting Consultant



Photographer - Anjie Blair



Heritage Architecture

Spring Bay Mill Event Space Interiors

GILBY + BREWIN ARCHITECTURE

Gilby + Brewin Architecture have utilised the existing buildings while remaining conscious of their industrial past.

Crossing the gang plank entrance to the Tin Shed, the visitor is located in the undercover double-height entry. Not only does this allow for connections between old and new, it also provides new gathering and performance possibilities.

From the big picture to the smallest details, Gilby + Brewin Architecture have remained focused on the principles of heritage and for this they are to be commended.

Dillon Builders | Builder
Marcus Ragus | Horticulturalist / Landscape Designer
Futago | Wayfinding Signage Design
Bury Kirkland Ferri | Interior Design Consultant (Banksia Room)
Saltmarsh and Escobar Consulting Engineers | Civil + Structural Consultants
Andrew Sutherland Consulting Engineers | Services Consultant
Eagle Ridge Consultants | Preliminary Stage Site-wide Project Management and Construction
Vanishing Point Design | Preliminary Stage Consultant Coordination, Design and Documentation
EHome AV | AV and Lighting Consultant
Laura McKusker | Furniture Designer (Banksia Room)

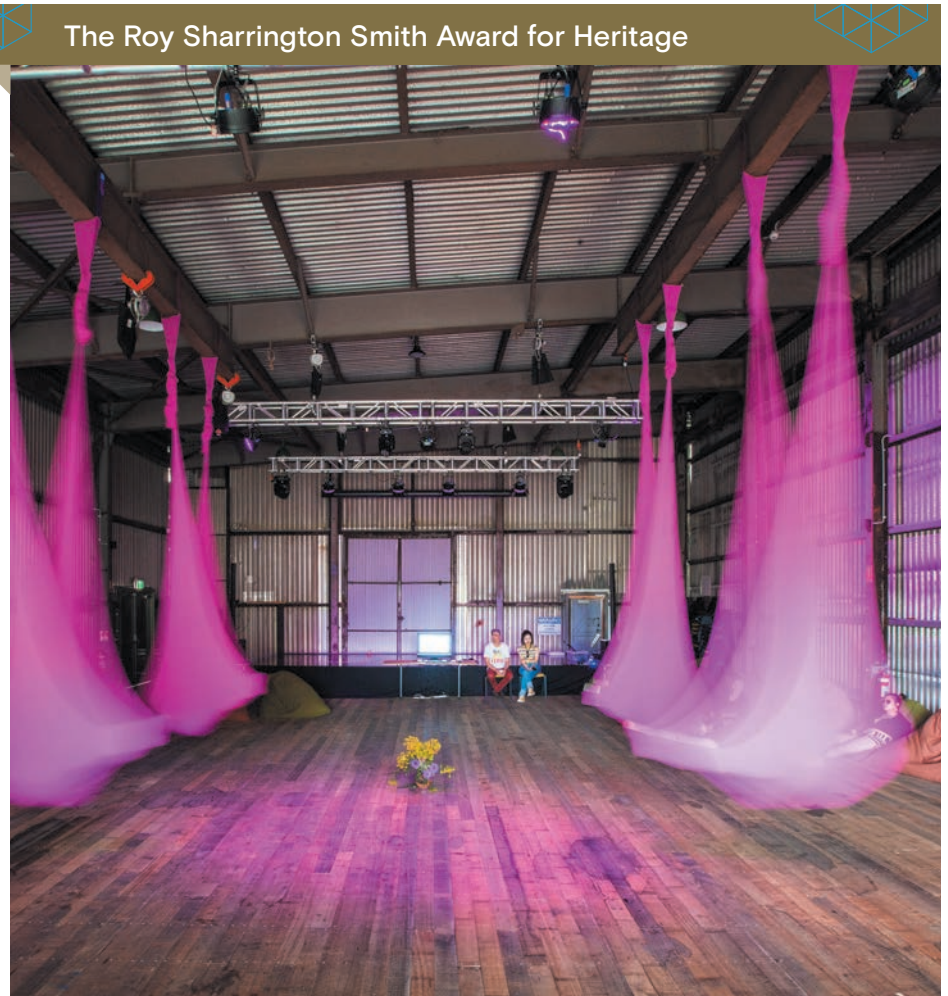

Photographer - Richard Jupe

Chapter Award

Signalman's Quarters

1+2 ARCHITECTURE

1+2 Architecture have successfully run the gauntlet of heritage overlays, codes, standards and conditions surrounding the Signalman's Quarters to create a sensitive, generous and light-filled home.

At the junction of the original 1850's Georgian cottage and the new addition, the architects bucked the trend of the glazed corridor and instead created an enclosed space with one perfectly proportioned skylight that aligns with the sidelight of the original door.

1+2 Architecture have deftly captained the project through the ups, downs and unknowns to create a rich, intricate and layered architecture that is referential yet without pastiche.

Delpero and Clements | Builder
Aldanmark | Structural, Civil & Hydraulic Engineer
Christopher Crack | Electrical Consultant
Leary Cox and Cripps | Land Surveyor
Praxis Environment | Heritage Consultant
Peter Ribbon Building Services | Services Consultant
Playstreet | Landscape Consultant



Photographer - Joe Grey



Public Architecture

Cradle Mountain Visitor Centre

CUMULUS STUDIO

Cumulus Studio's new Visitor Centre provides an excellent gateway to the Tasmanian Wilderness World Heritage Area.

Inspired by the immediate geology, the folded planes of the building create an ambiguity of scale, both formally and experientially. The perforated screens disguise an ingenious strategy of core and canopy, which reduces the area that needs to be heated and cooled and creates an interstitial space around the perimeter which can be used as ancillary shelter.

The composition of buildings and their siting within the built and natural landscape provides a strong yet playful architecture that is both iconic and responsive to the site.

Fairbrother Construction | Builder
Playstreet | Landscape Consultant
Futago | Wayfinding and Signage
Alex Miles | Artist (Installation)
Aldanmark | Engineer
COVA | Services Consultant
Pitt & Sherry | Electrical Consultant
NVC Acoustics | Acoustic Consultant

The Alan C Walker Award for Public Architecture

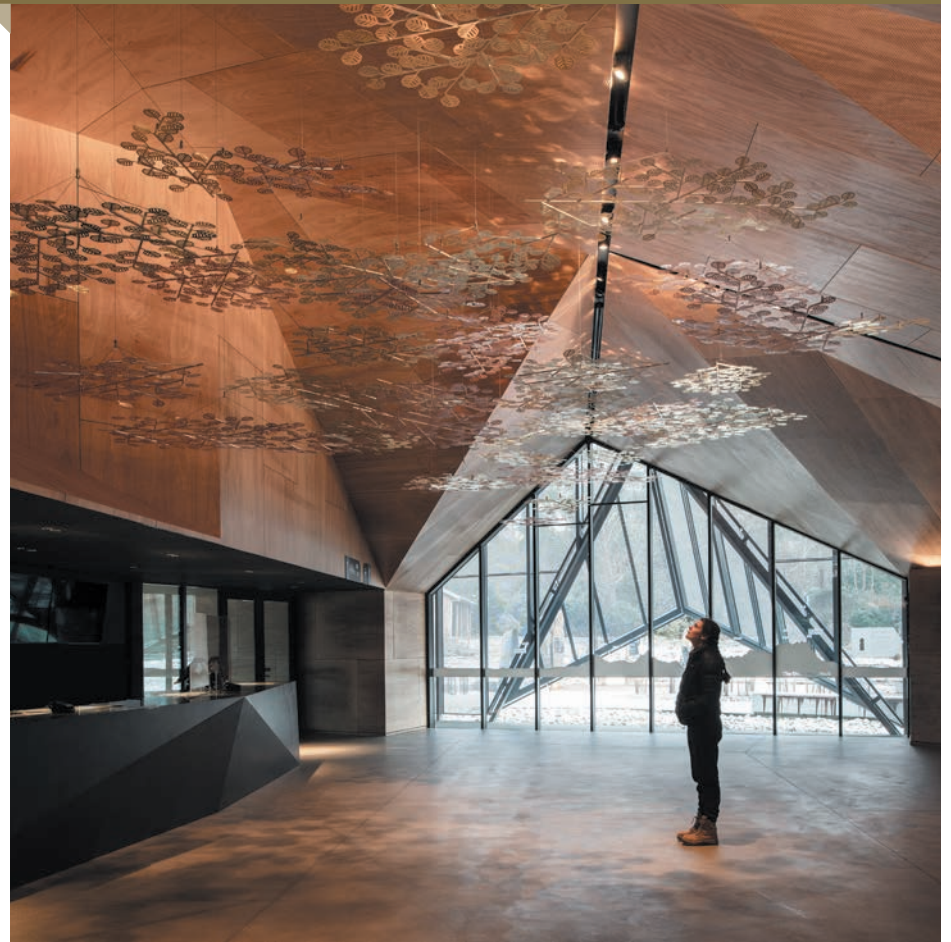

Photographer - Anjie Blair

Spring Bay Mill Event Spaces

GILBY + BREWIN ARCHITECTURE

In 2013, after purchasing and decommissioning the former Spring Bay Mill as a political stance against the state's controversial forestry industry, the client recognised that its transformation required a 'business model that works and an architect that listens.'

The first stage of the project comprises the new function room, performance space and auditorium. Each inventively balances the formation of protected micro-climates with a connection to expansive views beyond the site, towards Spring Bay and Maria Island.

This unique venue expands Tasmania's rich and diverse array of cultural activities beyond Hobart and provides a new cultural incubator for the East Coast.

Dillon Builders | Builder
Marcus Ragus | Horticulturalist / Landscape Designer
Futago | Wayfinding Signage Design
Bury Kirkland Ferri | Interior Design Consultant (Banksia Room)
Saltmarsh and Escobar Consulting Engineers | Civil + Structural Consultants
Eagle Ridge Consultants | Preliminary Stage Site-wide Project Management and Construction
Vanishing Point Design | Preliminary Stage Consultant Coordination, Design and Documentation

Chapter Award



Photographer - Richard Jupe



Residential Architecture

Houses (Alterations & Additions)

The Edith Emery Award for Residential Architecture

Arthur Circus

CIRCA MORRIS-NUNN CHUA ARCHITECTS

In one of Australia's most highly scrutinised heritage suburbs, Circa Morris-Nunn Chua have transformed a modest 2-bedroom worker's cottage into a deceptively spacious, light-filled home.

The original rooms of the house have largely been retained and used to accommodate flexible sleeping arrangements, a spacious galley-style kitchen and naturally lit bathroom.

The use of a single material to wrap the new living/dining room is reminiscent of a piece of fine furniture.

Cleverly considered skylights allow natural light into the deepest part of the house.

Arthur Circus delivers a sense of spaciousness and lightness that is completely unexpected on such a highly constrained site.

Lane Group | Builder
Aldanmark Engineers | Engineer
Pitt & Sherry | Building Surveyor
Praxis Environment | Heritage Consultant
Kate Loveday | Town Planner



Photographer - Matt Sansom

Chapter Award

Pirie Street Extension

PRESTON LANE

Preston Lane have skilfully created a harmonious space that elevates the rituals of daily life.

Stepping down the floor level of the addition settles it into the established cottage garden, creating fluid visual and physical connections between inside and out, and reserving the 'big' view of kunanyi for the sunken living room at the very end of the plan.

The complex material composition takes cues from the original 1910's cottage, continuing the weatherboards along the top of a new stone datum. The Pirie St project exemplifies a light and learned touch and a high level of expertise in crafting homes.

Langford Projects | Builder
Gandy and Roberts | Structural Engineer
Gandy and Roberts | Hydraulic Consultant
Holdfast Tas | Building Surveyor
Geo-Environmental Solutions | Geotechnical Engineer
Research Education Design | ESD Consultant
Rogerson & Birch Surveyors | Land Surveyor



Photographer - Adam Gibson



Photographer - Joe Grey

Signalman's Quarters

1+2 ARCHITECTURE

Strong and resolved forms characterise the Signalman's Quarters alterations and additions. 1+2 Architecture have reinterpreted the 'back of house' heritage requirements and created a bricolage of pitches, lean-tos and awnings that cleverly break down the scale of the addition from the street while artfully concealing a unified, generous and beautifully conceived space within.

Delpero and Clements | Builder
Aldanmark | Structural, Civil & Hydraulic Engineer

Explore the use of brick and block in contemporary architecture.

Materiality 2021

BRICKWORKS

www.brickworks.com.au

at your fingertips.



ACCESS
Solutions
access-solutions.com.au



SOUTHERN LIGHTING & DISTRIBUTION

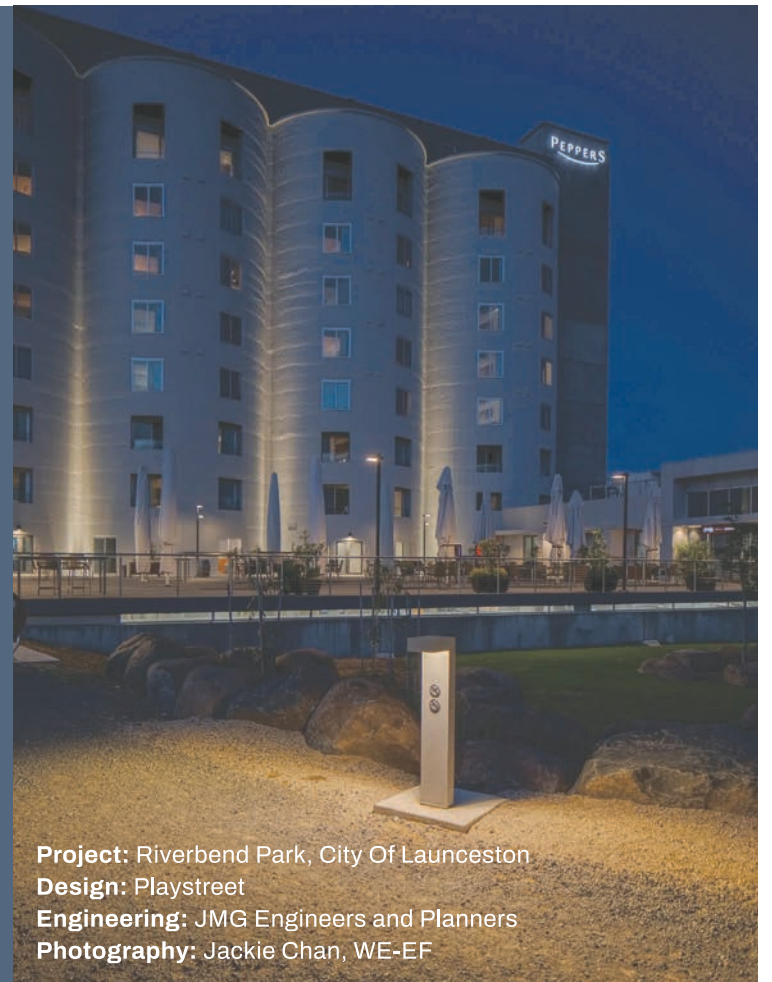

Project: Riverbend Park, City Of Launceston
Design: Playstreet
Engineering: JMG Engineers and Planners
Photography: Jackie Chan, WE-EF



Residential Architecture Houses (New)

Coopworth

FMD ARCHITECTS

A contemporary interpretation of a country farmhouse, Coopworth is located on a working sheep farm on Bruny Island. Drawing on vernacular traditions, the house is simultaneously reassuringly familiar and refreshingly new.

The building footprint is constrained to maximise arable land but provides a series of generous internal spaces. These can be compartmentalised, separating the open-planned living and mezzanine from the bedrooms and service areas, or opened out to create connectivity between spaces.

A very highly refined project, Coopworth demonstrates a mastery of form, space and material.

IN2 Construction | Builder
Aldanmark Consulting Engineers | Structural Engineer
MCE Building Design | Town Planner
HoldFast P/L | Building Surveyor
Blue Lotus | ESD Consultant
Prowse Quantity Surveyors P/L | Quantity Surveyor

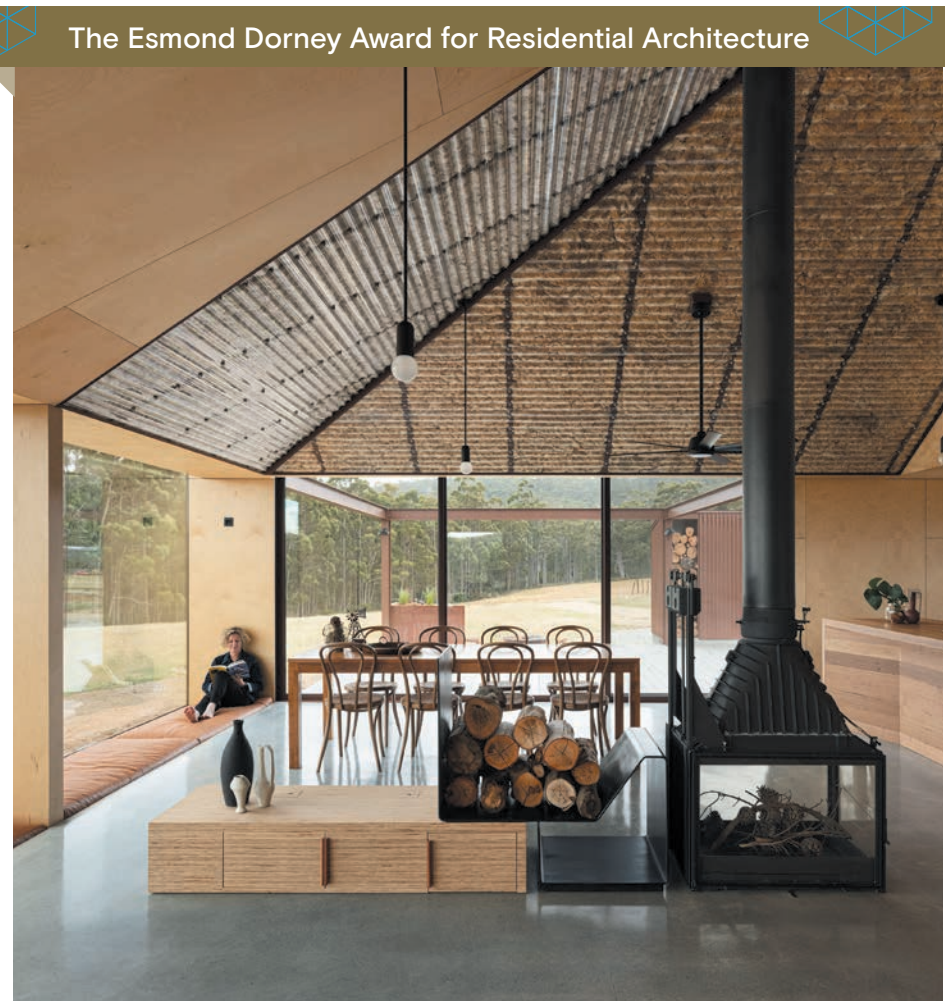

Photographer - Dianna Snape

Chapter Award

Killlora Bay

LARA MAESELE in association with
TANNER ARCHITECTS

Given the contextual constraints for Killlora Bay House, combined with the need to accommodate an extended family, the design challenges were considerable.

The project retains the natural values of the setting via sensitive site works, dark colours, timber cladding, and the restrained form. Yet it is sufficiently generous to be an informal indoor and outdoor living area and a place to store the paraphernalia of a holidaying family.

Sliding screens open views to the outside, while skylights draw the eye up resulting in a generous sense of space for a small house.

Killlora House is a delightful addition to the fast disappearing examples of Tasmanian shack culture.

Tim Watson + Driftwood Workshop | Builder
Tim Watson (Aldanmark) | Structural Engineer



Photographer - Adam Gibson

Commendation



Photographer – Adam Gibson

Cascade House

CORE COLLECTIVE ARCHITECTS

Cascade House is located on a unique historic internal lot, accessed via a landscaped laneway. Core Collective Architects have created a modest piece of liveable architecture. While the lower spaces open out to the east, the upper cultivated west terrace opens to the majestic mountain of kunanyi.

Childs Hodson | Builder
Gandy & Roberts Consulting Engineers | Engineer



Celebrating 20 years of supporting the Tasmanian Architecture Awards



Geelong College



Mona Siloam



Saffire



Cradle Mountain Gateway

Hobart • Devonport • Launceston • Bendigo • Warrnambool

www.fairbrother.com.au

McKAY TIMBER

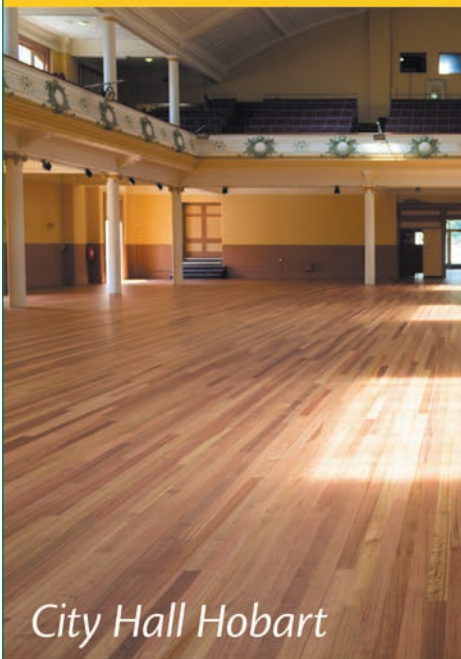

City Hall Hobart



Launceston Mall

www.mckaytimber.com.au

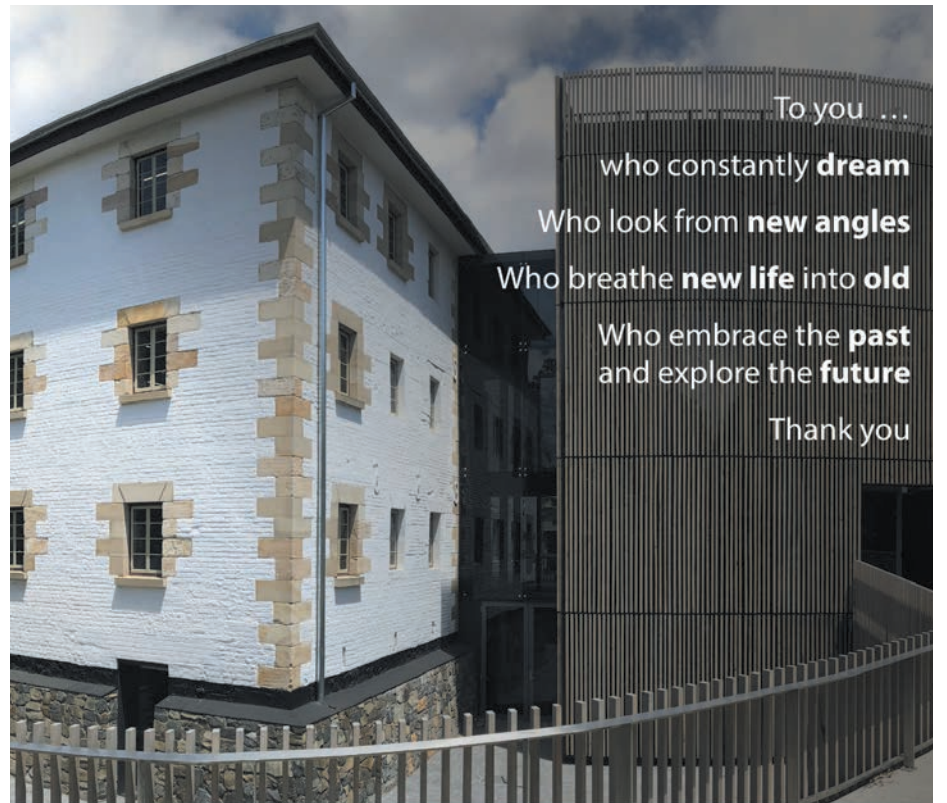

To you ...
who constantly **dream**
Who look from **new angles**
Who breathe **new life** into **old**
Who embrace the **past**
and explore the **future**
Thank you



Tasmanian Heritage Council



Small Project Architecture

Floating Sauna Derby

LICHT ARCHITECTURE

The Floating Sauna has been developed on the historic Brisies tin mine site, which flooded in 1929. Crossing the Ringaroona River, the 10-minute approach is an important part of the experience of this architecture.

As you enter the sauna, the contrasts from the chilled air to the smells and warmth of crackling wood and isolated view of the water body, bind the project to the surrounding nature.

The possibilities of being a part of the topography, and the ability of such projects to tell site-specific stories, makes for exciting architecture.

The result is an intriguing exemplar for future sustainable tourism development in the region.

Nigel Reeves | Builder
PFG Group | Pontoon Float

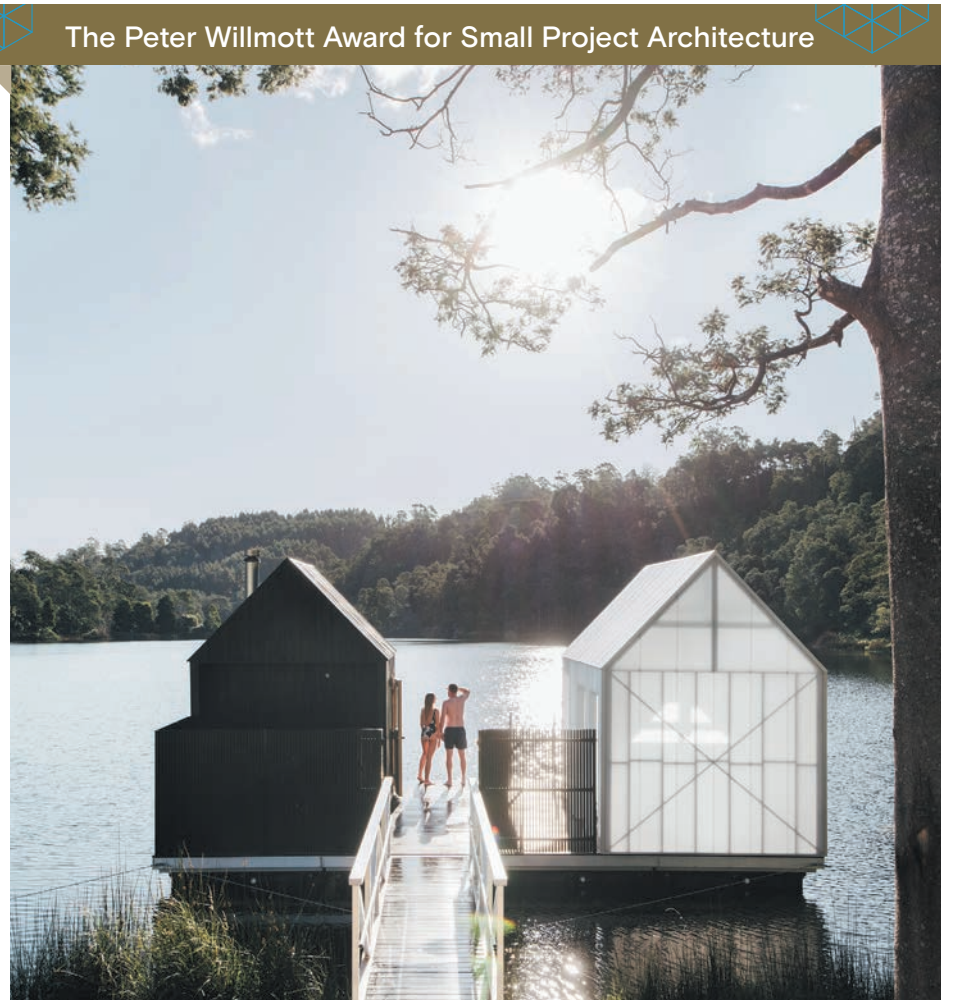

Photographer - Anjie Blair

The Peter Willmott Award for Small Project Architecture



Urban Design

Cradle Mountain Gateway Precinct

CUMULUS STUDIO

Cumulus Studio's Cradle Mountain Visitor Centre provides a new gateway for visitors to the Tasmanian Wilderness World Heritage Area.

Reusing the former airstrip to great advantage, the site planning and design creates a carefully orchestrated series of buildings and spaces.

Three small buildings house an information/site-orientation shelter, a couch and public toilet shelter and a shuttle bus shelter. Their playful black forms act as a counterpoint to the more angular grey, folded structure of the Visitor Centre. A generous courtyard is nestled within the fold of the main building, creating a place of arrival and departure that integrates seamlessly into this amazing site.

Fairbrother Construction | Builder
Playstreet | Landscape Consultant
Futago | Wayfinding and Signage
Alex Miles | Artist (Installation)
Aldanmark | Engineer
COVA | Services Consultant
Pitt & Sherry | Electrical Consultant
NVC Acoustics | Acoustic Consultant

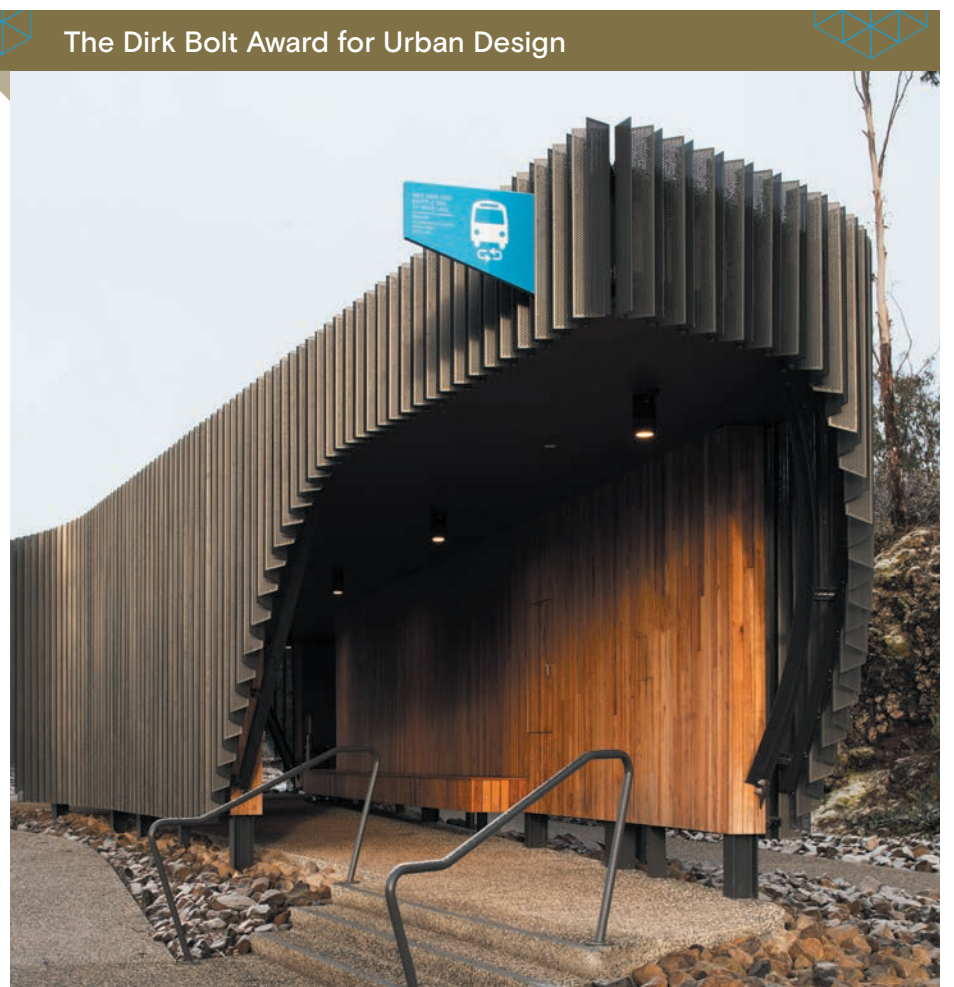

Photographer - Anjie Blair

The Dirk Bolt Award for Urban Design



Sustainable Architecture

Spring Bay Mill Stage 1

GILBY + BREWIN ARCHITECTURE
with MARCUS RAGUS

Once the largest wood chipping facility in the world, the Spring Bay Mill has been transformed into an events venue with a strong cultural and environmental focus.

Throughout, there has been a light touch to demolition and construction, with an eye to maintaining flexible spaces for a variety of uses.

Site remediation addresses contamination, and the expansive tarmac is being progressively replaced to reduce impact on the storm water system. Engaging with local builders, fabricators and tradies has also provided a boost for the local economy, which will continue as the site develops into a key visitor destination on the East Coast.

Dillon Builders | Builder

Marcus Ragus | Horticulturalist / Landscape Designer

Futago | Wayfinding Signage Design

Bury Kirkland Ferri | Interior Design Consultant (Banksia Room)

Saltmarsh and Escobar Consulting Engineers | Civil + Structural Consultants

Eagle Ridge Consultants | Preliminary Stage Site-wide Project Management and Construction

Vanishing Point Design | Preliminary Stage Consultant Coordination, Design and Documentation

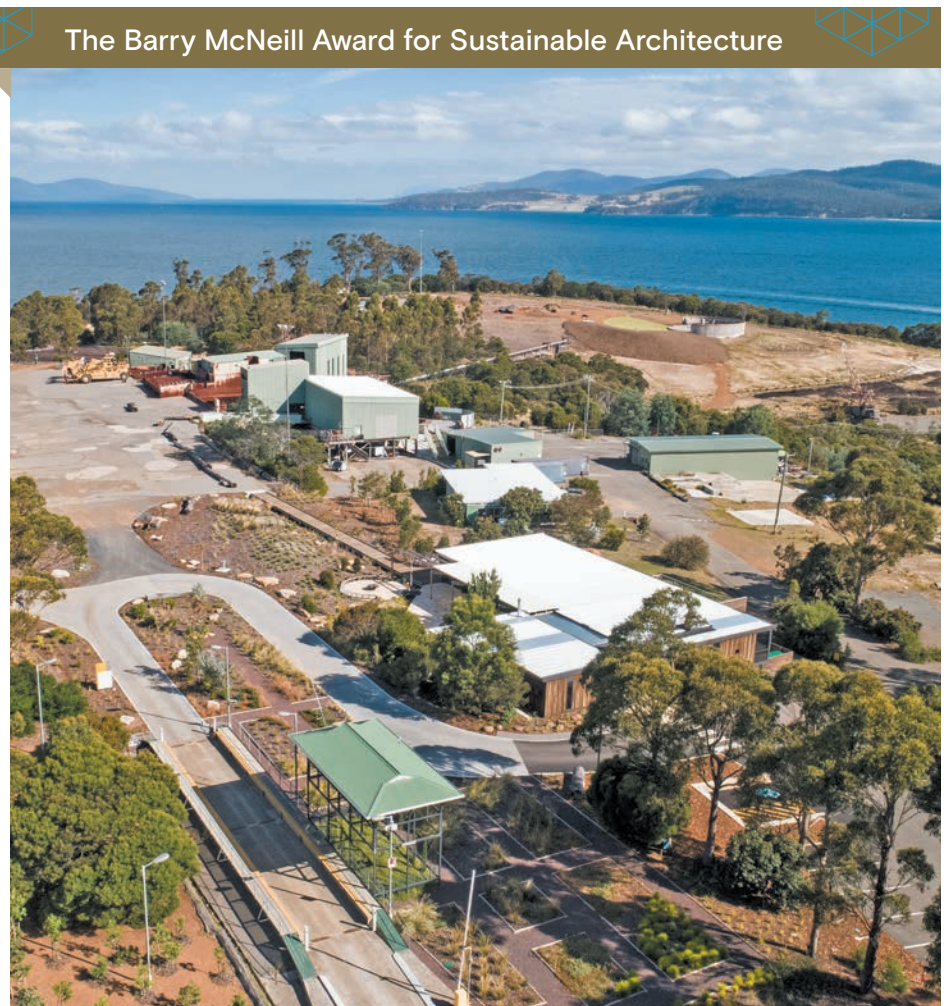

Photographer – Richard Jupe

The Barry McNeill Award for Sustainable Architecture



Enduring Architecture

Wilson Robson Building 191–193 Liverpool Street Hobart

HARTLEY WILSON OLDMEADOW
EASTMAN WALCH ARCHITECTS

The 1960s heralded the emergence of the hitherto unknown 'besser block' into the architect's vocabulary. Brian Walch emerged in this era, rising from student to architect partner with the firm Hartley Wilson Oldmeadow Eastman Walch. He worked with Dirk Bolt in pioneering concrete blockwork expression in the celebrated Christ College and Scottish Union buildings.

The Wilson Robson building (1973) was Brian's first commercial project. These accounting firm offices, within a simple rectangular three-storey corner site building, exemplifies a minimalist commercial architecture that explores the use possibilities of inexpensive materials, textured off-form concrete and block, and works towards a simplified philosophy of expression.

The Wilson Robson building is an outstanding building, representative of an important phase in the evolution of Tasmanian architecture.

Smith and Sale | Structural Engineers

Ford Hing Pty Ltd | Owners

Chapter Award



Photographer – Genevieve Lilley



Tasmanian Architecture Medal

MOSS 25

CIRCA MORRIS-NUNN CHUA
ARCHITECTS

Circa Morris-Nunn Chua have created an unexpected set of diverse experiences that encourage and reward curiosity.

Throughout the interior, the original fabric is retained and celebrated, displaying the delicate process of restoring a heritage building and constructing a deceptively tall precast addition behind Hobart's iconic Salamanca Place.

Inside the new section of the hotel the room pods have been assembled to create a type of hidden micro village, further cementing the feeling of being inside a hidden world.

This is a wonderfully complex piece of architecture.

Vos Construction & Joinery | Builder
SMG | Project Manager
Pitt & Sherry | Building Surveyor
Behrakis Group | Developer
Aldanmark Engineers | Engineer



Photographer - Adam Gibson

Build your brand
for the future
through 'brand
conscious creativity'.

futago_

Brand conscious creativity.

SUPPORTER OF THE TASMANIAN ARCHITECTURE
AWARDS & DESIGN PARTNER OF OPEN HOUSE HOBART.

OPEN HOUSE

LAUNNIE Sat 28 Aug

HOBART Sat+Sun 13+14 Nov



openhousehobart.org



Architecture Prizes

SWT Blythe Student Prize

Lost and Found

HAMISH SAUL

Lost and Found is an evocative adaptive reuse project which focuses on simple insertions and spatial progression through both the site and existing buildings. Set in the town of Longford, Tasmania, this project transforms the former Baptist Tabernacle into an experienced-based public exhibition space.

Designed to revitalise the site, the concept alters the user experience through considered ground plane manipulation. A choreographed journey through a series of external and internal spaces offers moments of intrigue, immersion, isolation and reflection. Resolution of conceptual thinking is demonstrated using refined 2D and 3D diagrams and detailing that clearly articulates the transitions from a sunken courtyard to subterranean tunnels, passing displayed artefacts, and using elevated walkways to connect with shallow pools that reinterpret historical flood events, before reaching a viewing platform overlooking the town.

The project demonstrates a mature approach to the brief; thorough research and analysis of the site and its broader historical, cultural and social context has resulted in a succinct expression. The project is a sensitive adaption of the heritage fabric with careful incisions in a contemporary manner, displaying the town's rich history and encouraging public interaction. Congratulations Hamish.

SWT Blythe Student Prize



Commendation

The Hang-Out

EMILY HUNT

The Hang-Out is a community-based project which demonstrates careful consideration to community ownership and provides a flexible space that can be adapted according to user needs. The architectural approach is centred around a simple but innovative concrete waffle pod canopy that houses integrated building services. This delivers an effective, adaptable solution for multiple functions. This project demonstrates a deep contextual understanding of the location. Emily is to be commended for her ability to present an analytical and conceptual approach to her thinking. Expressed clearly through diagrams and 3D imagery, the outcome articulates the possibilities of doing more with less.



Architecture Prizes

Emerging Architect Prize

Emily Ouston

CORE COLLECTIVE

Emily Ouston is recognised for her excellence in both architectural practice and her leadership in design research and education, as well as advocacy for gender and social equity, sustainability and human rights. Her extensive skill set is demonstrated through her ability to navigate complex user groups, nurture meaningful collaborations and incorporate these into sustainable and astute architecture. This success is reflected by the multiple award-winning projects she has contributed to.

Emily has made honourable contributions to the Tasmanian architectural community through her role as a Chapter Councillor and as Vice-President of the Tasmanian Chapter of the Institute, and through her volunteer work for Australian Architects Declare. Emily weaves her environmental and social values through a determined architectural practice. She advocates for people and sustainability, while contributing selflessly to the community, and is an architect worthy of this high commendation.

Chapter Award



TASMANIAN ARCHITECTURE AWARDS 2021

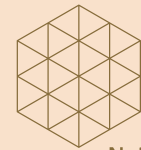

National
Architecture
Awards



Australian
Institute of
Architects



Aotea House,
Britten Pace



Kelvedon Park,
AKA architects



Royal Hobart Hospital
Redevelopment,
Lyons with Terroir



Arthur Circus,
Circa
Morris-Nunn
Chua Architects



Killora Bay,
Lara Maesele in
association with
Tanner Architects



Signalman's
Quarters,
1+ 2 Architecture



Cascade House,
Core Collective
Architects



Kurukuru
Restaurant,
Licht Architecture



Spring Bay Mill,
Gilby + Brewin
Architecture with
Marcus Ragus



Coopworth,
FMD Architects



MOSS 25,
Circa
Morris-Nunn
Chua Architects



STATE GROWTH -
TRANSPORT FITOUT,
biotope
architecture.
interiors

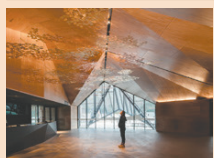

Cradle Mountain
Gateway Precinct &
Visitor Centre,
Cumulus Studio



Pine Flat Lodge,
Room 11

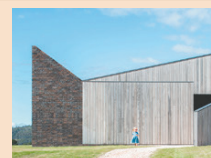

Stoney Rise Wine,
Cumulus Studio



Floating Sauna
Derby,
Licht Architecture

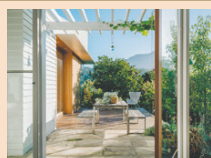

Pirie Street
Extension,
Preston Lane

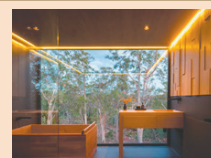

Summerleas
Road,
AKA architects



Glass House,
Room 11

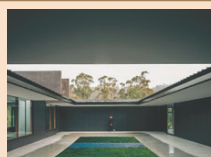

Rain Curtain
House,
Room 11

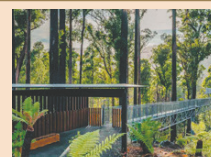

Tahune Airwalk
Pavilion,
Tanner Architects

Vote for your favourite piece of architecture and you could win prizes!

Voting in the People's Choice closes Wednesday 30 June 2021.
Winners will be notified by Thursday 15 July 2021.

To vote, visit the website via the QR code or go to: architecture.com.au/awards/2021-awards/entrant-gallery-tasmanian-chapter-2021.

